

Assessor's Plat-Book for Blue Creek Township, No. 29

NAMES OF OWNERS.	Number on Plat.	DESCRIPTION.	Section.	Township.	Range.	Acres.	Hundredths.	Value of	Value of	Value of
								Lands.	Improvements.	Lands and Improvements.
Myers Jacob		N cor Ne Ne	15	26	15	10		160	50	210
John Zasad										
Ruby W ^{rs}		Mid pt Npt Ne Ne	15	11	11	25		320	85	405
Edwards Lewis		Nw	11	11	11	160		2520	900	2820
		Ne Sw	11	11	11	40		440	200	640
Petular Jeff		Spt N/2 Ne	11	11	11	80		465	195	660
Edwards Wm		S/2 Ne	1	11	11	80		1280	125	1405
Ripley John		N/2 Se	12	11	11	40		640	25	665
		Sw Sw Sw Se	11	11	11	40		160		160
		Se Sw	2	11	11	40		640	150	790
James Robert		Nw Se	11	11	11	40		640	270	910
Jayne John		N/2 Sw	11	11	11	80		1230	600	1830
Hoblet James		Se Se	11	11	11	40		640	150	790
Ripley Elizabeth		Ept Sw Se	11	11	11	80		465	300	765

Section No. 15

Congressional Township No. 26, R. 10

Scale—Forty rods to an inch, or ten rods to a space, Congress Land, which is one mile square for a section.
Number of acres in this section, according to the United States Survey, 340

Lewis Edwards
160 Ac

John Geasel

W^m Ruby
10 Ac

Jacob
Myers
10 Ac

Jeffy Stutter
40

W^m Edwards
80 Ac

John Gagne
80 Ac

Lewis Edwards

Robert Vance
40 Ac

John Ripley
40 Ac

John Ripley

John Ripley
40 Ac

James Hoblet
40 Ac

160
150
140
130
120
110
100
90
80
70
60
50
40
30
20
10
1
10
20
30
40
50
60
70
80
80
100
110
120
130
140
150
160

160
150
140
130
120
110
100
90
80

Assessor's Plat-Book for Blue Creek Township, No. 12

NAME OF OWNER.	DESCRIPTION.						Value of Crops.	Value of Improvements.	Value of Land and Improvements.
		1	2	3	4	5			
Myles Jacob	Ne Ne	16	16	11	20	600	220	820	
Sizer C. A.	Ne Ne	17	17	11	20	220	210	430	
Young Henry	Ne Ne	18	18	11	20	620	190	810	
Kewit Joshua	Ne Ne	6	7	11	20	520	120	640	
Bruders G. Emanuel	Ne cor Sw Ne	15	15	11	20	190	70	260	
Shenbury John	Sw cor Sw Ne	14	14	11	20	135	95	230	
	W. Sw Ne	11	11	11	20	300	120	420	
Young W. C.	Sw Ne	11	11	11	20	520	200	720	
	Ne cor Sec 12 Ne	11	11	11	20				
Campbell Sylvester	Sec cor Se Ne	11	11	11	20				
	Sw Ne	11	11	11	20	530	70	600	
Vague John	Se Ne	11	11	11	20				
	Ne Se	11	11	11	20				
Campbell S.	Ne Se	11	11	11	20	1200	500	1700	
John Vague	Se Ne	11	11	11	20	640	90	730	
	Ne Se	11	11	11	20	1200	370	1570	
Christy Margaret	Ne Sw	11	11	11	20	1150	280	1430	
Thicker George	W. cor Sw	11	11	11	20	650	200	850	
John Young	Sw cor Ne Sw	11	11	11	20	180	140	320	

Section No. 10

Congressional Township No. 26, R. 10

Scale—Forty rods to an inch, or ten rods to a space, Congress Land, which is one mile square for a section.
Number of acres in this section, according to the United States Survey. 341

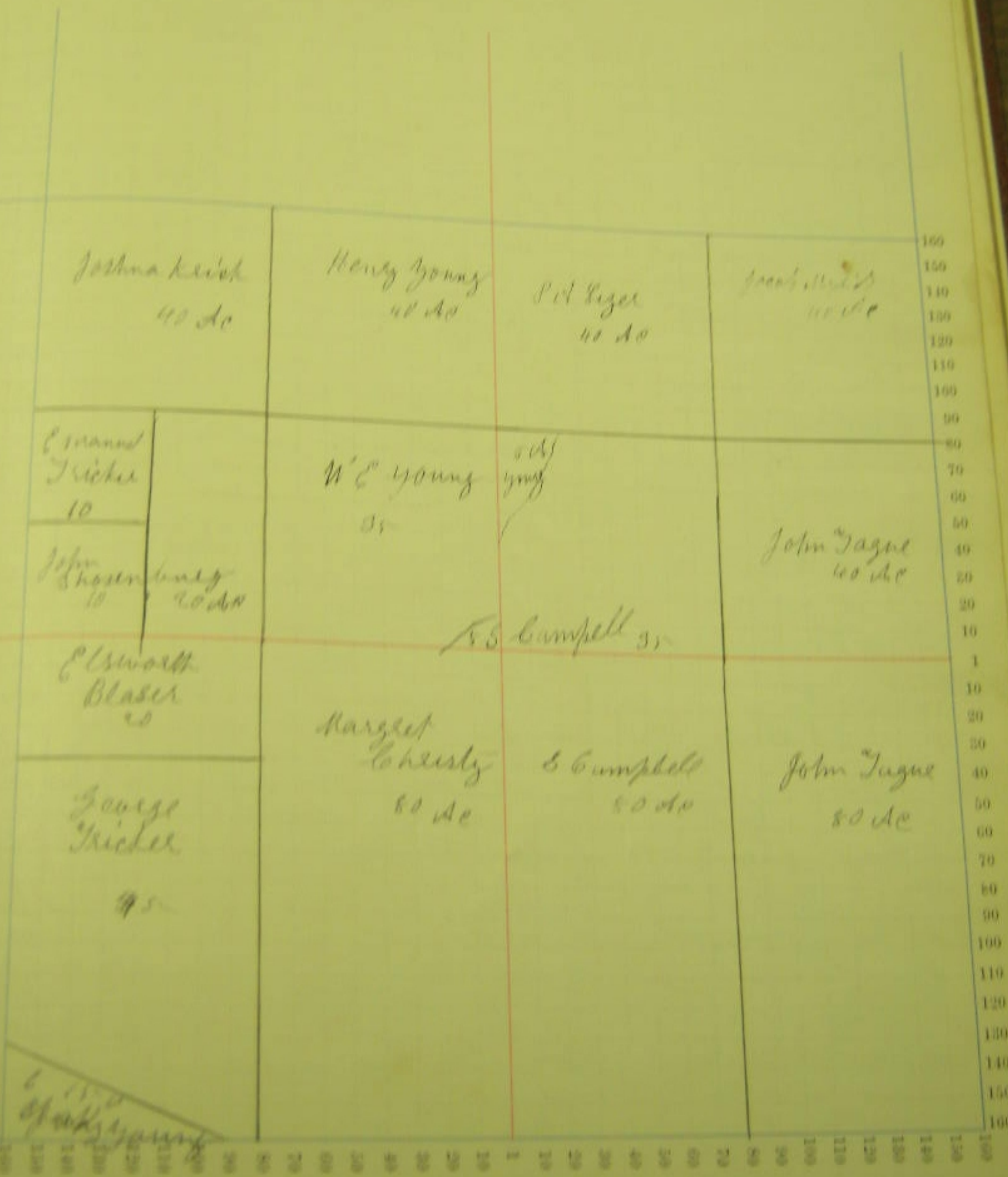

NAMES OF OWNERS	DESCRIPTION	Section	Township	Range	Acres	Hundredths	Value of	Value of	Value of
							Lands	Improvements	Lands and Improvements
Dary Joshua	Ne Ne	19	26	11	90		640	250	890
Campbell Wm	Nt Wt Ne	11	11	11	60		730	400	1130
McAlhany Joe	pt Ee Ne Sw	11	11	11	3	65	50	75	125
Matnee Catharine	Nt Ee Ne Sw								
Merriman Eliza	pt Ee Ne Sw								
Jewey	pt Ee Ne Sw	11	11	11	5		70	65	135
Oske Leance	Med pt Ne Ne Sw	1	11	11	10		160	50	210
Marty Philip	pt Ee Ne Sw	11	11	11	10		160	100	260
Boyer Richy	Spt Ee Ne Sw	11	11	11	10		150	50	200
	Spt Wt Ne	11	11	11	20		310	100	410
	Ne Ne								
Shasembury John	pt Wt Se	1	11	11	90				
King Jesse	Ne Se	11	11	11	39		585	141	726
Bedding W C	Ne Sw	11	11	11	40		620	500	1120
	Nw Se	11	11	11	40		620	200	820
Davis Nancy	E pt Nw Sw	11	11	11	25		385	150	535
Davis Robert	W pt Sw Sw	11	11	11	15		230	50	280
Yunkham Lorenzo	Sw Sw	11	11	11	80		1200	300	1500
Fisher Arthur	Sw Se	11	11	11	80		1210	350	1560
N Janet Bevan	Nw cor Nw Nw	11	11	11	1		15	10	25
Davis Amos	pt Nw Nw	11	11	11	10		310	140	450
Deaman Florence et al	pt Nw Nw	11	11	11	13		200	190	390
Davis Charles T	pt Nw						12	5	17
Doughman Rachel	pt Sw Nw	11	11	11	14		27	225	252
Campbell Rebecca J	pt S Ne Sw						25	5	30
Cawson Joe	se Nw cor	11	11	11	1	62	25	15	40
Mace Elizabeth J	pt Sw Nw						20	90	110
Malone Catharine	S pt Ne Sw						55	40	95
Merriman Eliza	pt Nw Nw						65	120	185

Section No. 17

Congressional Township No. 26, R. 15

Scale—Forty rods to an inch, or ten rods to a space, Congress Land, which is one mile square for a section.
Number of acres in this section, according to the United States Survey, _____

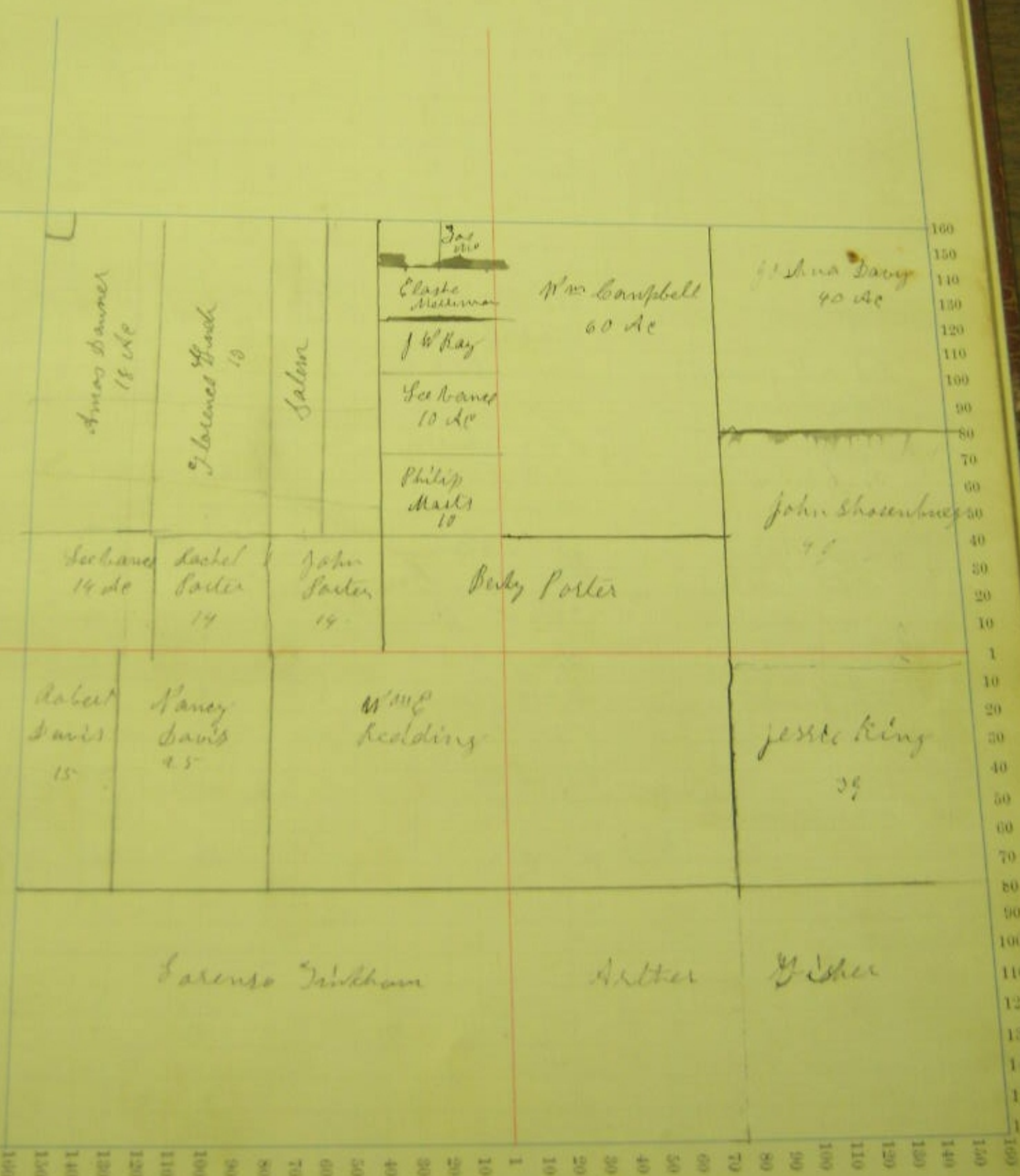

NAMES OF OWNERS.	Number on Plat.	DESCRIPTION.	Section.	Township	Range.	Acres.	Mounds.	Value of Land.	Value of Improvements.	Value of Land and Improvements.
Bryan Dingley		Ne Ne	18	24	13	40		600	300	900
		Mid pt E 1/2 Se	21	24	13	7.50		400	50	450
Shroll Joseph		w 1/2 Ne	1	11	11	80		1240	440	1680
Wells Hannah		Nept Nw	11	11	11	20		310	40	350
Amy Moore		Nen Nw	11	11	11	40		600	200	800
		N 1/2 Ne Nw	1	11	11	40		600	25	625
		W 1/2 Se Nw	1	11	11	20				
Zeiber Adam		Sw Nw	11	11	11	40		615	175	790
Plants Sarah		N 1/2 W 1/2 Sw	11	11	11	50		750	800	1550
Morgan Abe		Spt E 1/2 Nw	11	11	11	39		450	120	570
Wester Frank		W 1/2 E 1/2 Sw	11	11	11	80		1240	300	1540
Hook Joseph		W 1/2 Sw Se	11	11	11	50		795	175	970
Joseph base		E 1/2 W 1/2 Se	11	11	11	30		590	90	680
		Spt Se Se	11	11	11	20		500	150	650
Bryan John		Se Ne	11	11	11	40		620	200	820
		pt E 1/2 Se	11	11	11	30		485	90	575
Wells David J		E 1/2 Se Nw	1	11	11	60		310	125	435

Section No. 18

Congressional Township No. 26, R. 15

Scale—Forty rods to an inch, or ten rods to a space, Congress Land, which is one mile square for a section.
Number of acres in this section, according to the United States Survey.

