

SECTION No. 27

Congressional Township No. 26 N, R. 13 W

SCALE: Forty rods to an inch, or ten rods to a space, Congress Land, which is one mile square for a section.

Number of acres in this section, according to the United States Survey,



COUNTY, INDIANA, 19

Assessor's Plat-Book for

Blue creek

Township, No. 26

| NAMES OF OWNERS | Number on Plat | DESCRIPTION | Section | Township | Range | Acres | Hundredths | Value of Lands | Value of Improvements | Value of Lands and Improvements |
|-----------------------|----------------|-------------------------|---------|----------|-------|-------|------------|----------------|-----------------------|---------------------------------|
| John. N. Smittery | 1 | n.w. 1/4 n.w. 1/4 | 28 | 26 | 15 | 40 | | 1360 | 450 | 1810 |
| John. W. Sipe | 2 | s.w. 1/4 n.w. 1/4 | | | | 40 | | 1350 | | 1350 |
| O. N. Tyndall | 3 | E 1/2 n.w. 1/4 | 28 | 26 | 15 | 80 | | 2670 | 480 | 3150 |
| Joseph J. Dailoy | 4 | w 1/2 n.e. 1/4 | | | | 80 | | 2700 | | 2700 |
| Davidson Mattar | 5 | e 1/2 n.e. 1/4 | | | | 80 | | 2730 | | 2730 |
| Solaman Jurgentill | 6 | w 1/2 pt e 1/2 s.w. 1/4 | | | | 100 | | 3320 | 450 | 3770 |
| John. A. Clouser | 7 | pt e 1/2 s.w. 1/4 | | | | 90 | | 2950 | | 2950 |
| do | | pt w 1/2 s.e. 1/4 | | | | | | | | |
| Sylvester. C. Tinkham | 8 | e pt s.e. 1/4 | | | | 130 | | 4360 | 580 | 4940 |

SECTION No. 28

Congressional Township No. 26 N, R. 15 W

SCALE: Forty rods to an inch, or ten rods to a space, Congress Land, which is one mile square for a section.

Number of acres in this section, according to the United States Survey,

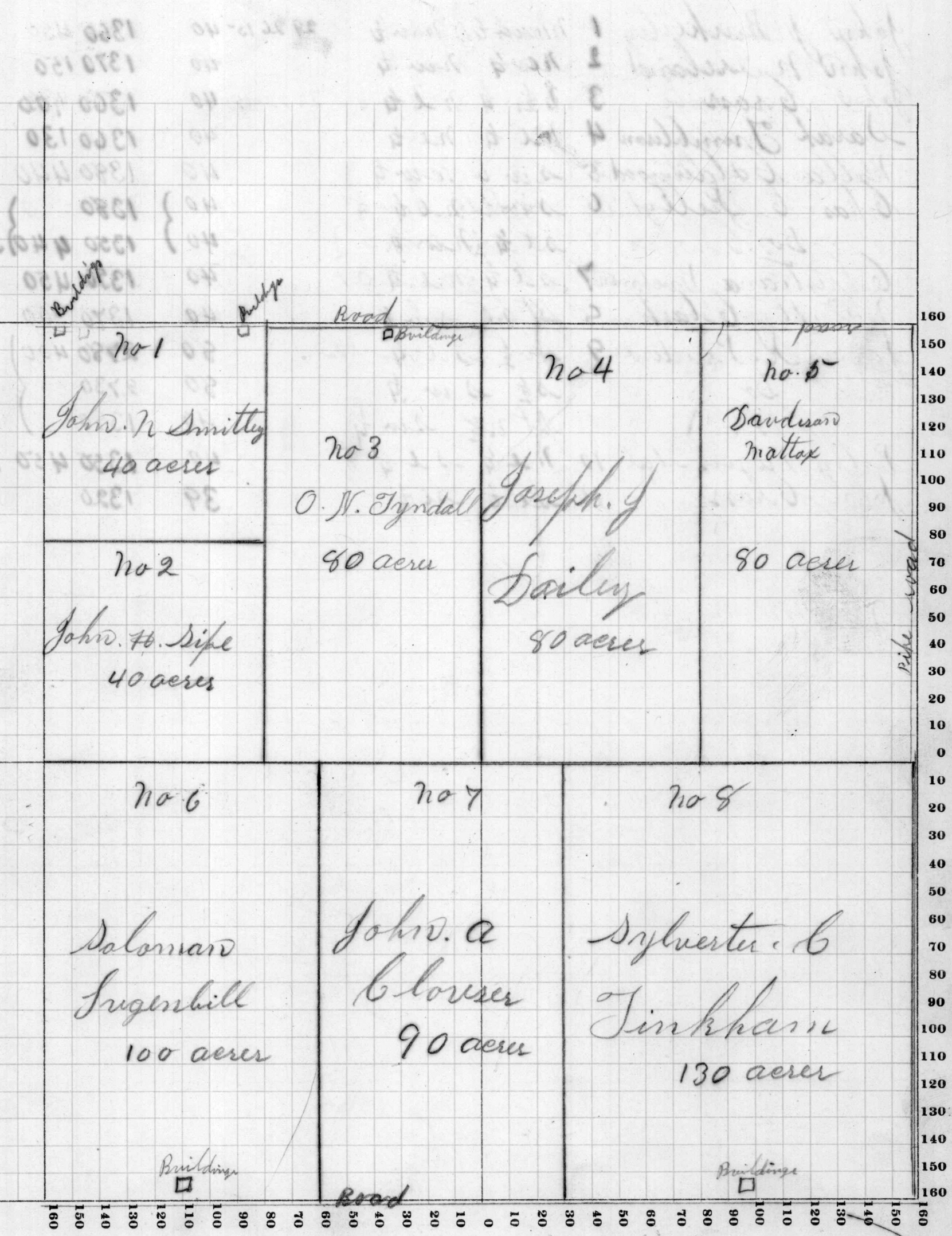

Assessor's Plat-Book for

Blue Creek

Township, No. 26

| NAMES OF OWNERS | Number on Plat | DESCRIPTION | Section | Township | Range | Acres | Hundredths | Value of Lands | Value of Improvements | Value of Lands and Improvements |
|----------------------|----------------|------------------|---------|----------|-------|-------|------------|----------------|-----------------------|---------------------------------|
| John J. Bruke | 1 | nw 1/4 nw 1/4 | 29 | 26 | 15 | 40 | | 1360 | | 1360 |
| John N. Ireland | 2 | ne 1/4 nw 1/4 | | | | 40 | | 1370 | 150 | 1520 |
| John Cross | 3 | nw 1/4 ne 1/4 | | | | 40 | | 1360 | 100 | 1460 |
| Sarah Trumbler | 4 | ne 1/4 ne 1/4 | | | | 40 | | 1360 | 130 | 1490 |
| Rella Calderwood | 5 | sw 1/4 nw 1/4 | | | | 40 | | 1380 | 440 | 1820 |
| Chas. C. Kelly | 6 | sw 1/4 ne 1/4 | | | | 40 | } | 1380 | } | 3190 |
| do | | se 1/4 nw 1/4 | | | | 40 | | 1350 | | |
| Christiana Brehanter | 7 | se 1/4 ne 1/4 | | | | 40 | | 1350 | 450 | 1800 |
| Wm. H. Clark | 8 | pt ne 1/4 sw 1/4 | | | | 40 | | 1370 | 300 | 1670 |
| James H. Pruden | 9 | sw 1/2 se 1/4 | | | | 80 | } | 2780 | 400 | 7290 |
| do | | se 1/2 sw 1/4 | | | | 80 | | 2730 | | |
| do | | pt ne 1/4 sw 1/4 | | | | 40 | | 1380 | | |
| Betty Meyers et al | 10 | ne 1/4 se 1/4 | | | | 40 | | 1350 | 450 | 1800 |
| John Cross | 11 | se 1/4 se 1/4 | | | | 39 | | 1320 | | 1320 |

SECTION No. 29

Congressional Township No. 261, R. 11-

SCALE: Forty rods to an inch, or ten rods to a space, Congress Land, which is one mile square for a section.

Number of acres in this section, according to the United States Survey,.....



Assessor's Plat-Book for

Blue creek

Township, No. *26*

| NAMES OF OWNERS | Number on Plat | DESCRIPTION | Section | Township | Range | Acres | Hundredths | Value of Lands | Value of Improvements | Value of Lands and Improvements |
|--------------------------|----------------|----------------------------|-----------|-----------|-----------|-----------|------------|----------------|-----------------------|---------------------------------|
| <i>Lewis J. Clark</i> | <i>1</i> | <i>w 1/2 n w 1/4</i> | <i>30</i> | <i>26</i> | <i>15</i> | <i>80</i> | | <i>2720</i> | <i>600</i> | <i>3320</i> |
| <i>Wm Stauffer</i> | <i>2</i> | <i>n e 1/4 n w 1/4</i> | | | | <i>40</i> | | <i>1370</i> | | <i>1370</i> |
| <i>Joseph O Malamy</i> | <i>3</i> | <i>w 1/2 n e 1/4</i> | | | | <i>80</i> | | <i>2760</i> | <i>600</i> | <i>3360</i> |
| <i>Wm Roudenbush</i> | <i>4</i> | <i>w 1/2 e 1/2 n e 1/4</i> | | | | <i>40</i> | | <i>1340</i> | <i>400</i> | <i>1740</i> |
| <i>John J. Buske</i> | <i>5</i> | <i>e 1/2 e 1/2 n e 1/4</i> | | | | <i>40</i> | | <i>1350</i> | <i>180</i> | <i>1530</i> |
| <i>John J. Hoaligger</i> | <i>6</i> | <i>s e 1/4 n w 1/4</i> | | | | <i>40</i> | | <i>1340</i> | <i>400</i> | <i>1740</i> |
| <i>Do</i> | | <i>pt n e 1/4 s w 1/4</i> | | | | <i>19</i> | | <i>630</i> | | <i>2370</i> |
| <i>Matthias Miller</i> | <i>7</i> | <i>w 1/2 s w 1/4</i> | | | | <i>80</i> | | <i>2720</i> | | <i>2720</i> |
| <i>Anna Stone</i> | <i>8</i> | <i>pt n e 1/4 s w 1/4</i> | | | | <i>4</i> | | <i>140</i> | <i>10</i> | <i>150</i> |
| <i>Philip Wendel</i> | <i>9</i> | <i>s e 1/4 s w 1/4</i> | | | | <i>40</i> | | <i>1330</i> | | |
| <i>Do</i> | | <i>pt n e 1/4 s w 1/4</i> | | | | <i>17</i> | | <i>450</i> | <i>140</i> | <i>1920</i> |
| <i>Royal Ayers et al</i> | <i>10</i> | <i>e 1/2 s e 1/4</i> | | | | <i>80</i> | | <i>2640</i> | | |
| <i>Do</i> | | <i>pt w 1/2 s e 1/4</i> | | | | <i>70</i> | | <i>2310</i> | <i>560</i> | <i>5510</i> |
| <i>Hartford Oil Co</i> | <i>11</i> | <i>pt w 1/2 s e 1/4</i> | | | | <i>10</i> | | <i>320</i> | | <i>320</i> |

SECTION No. 30

Congressional Township No. 26 N, R. 15 W

SCALE: Forty rods to an inch, or ten rods to a space, Congress Land, which is one mile square for a section.
 Number of acres in this section, according to the United States Survey,

