

Adams

COUNTY, INDIANA, 1907.

Assessor's Plat-Book for

Blue Creek

Township, No. 26

P. B. T. 1907. 1907. 1907. 1907.

NAMES OF OWNERS.	Number of Pts.	DESCRIPTION.	Section.	Township.	Range.	Acres.	Hundredths.	Value of Land.	Value of Improvements.	Value of Land and Improvements.
Cristy Samuel K		nw	se	27	26	15	40	500	80	
Hobell Boston		pt $\frac{1}{2}$	nw	27			50	1450	450	
		pt $\frac{1}{2}$	ne	27			20	560		
Dudgion Douglas		e pt	ne	27			140	3765	400	
Grim Martha E.		ws $\frac{1}{2}$	sw	27			79	2170	500	
Jones James W.		ws $\frac{1}{2}$	nw	27			80	2240	300	
		w pt $\frac{1}{2}$	nw	27			30	840		
Trinkham Elizabeth		pt $\frac{1}{2}$	sw	27			27	50	743	350
Trinkham Rebecca		pt $\frac{1}{2}$	sw	27			25	570	150	
Trinkham Sylvester C.		pt $\frac{1}{2}$	sw	27			27	50	743	
Sipe Andrew J.		se	se	27			40	1080	200	
Sipe John H.		ne	se	27			40	1080		
Sipe J. L.		sw	se	27			41	1080		

SECTION No. 27

Congressional Township No. 26, R.

SCALE—Forty rods to an inch, or ten rods to a space, Congress Land, which is one mile square for a section.  
Number of acres in this section, according to the United States Survey,

Value of  
Improvements.

80

80

80

80

80

80

80

80

80

80

80

80

80

80

80

80

80

80

80

80

80

80

80

80

80

80

80

80

80

James M Jones  
110

Boston Fishlet  
20  
20

Douglas Dudgeon  
140

Martha E. Erine  
79

Sylvester C. Tinkham  
27 32

Rebecca Tinkham  
25.

Elizabeth Tinkham  
27 32

Samuel K. Christy  
40

John H. Sipe  
40

J. L. Sipe  
40

Andrew J. Sipe  
40

160  
150  
140  
130  
120  
110  
100  
90  
80  
70  
60  
50  
40  
30  
20  
10  
1  
10  
20  
30  
40  
50  
60  
70  
80  
90  
100  
110  
120  
130  
140  
150  
160



SECTION No. 28

Congressional Township No. 26, R.

SCALE—Forty rods to an inch, or ten rods to a space, Congress Land, which is one mile square for a section.  
Number of acres in this section, according to the United States Survey.

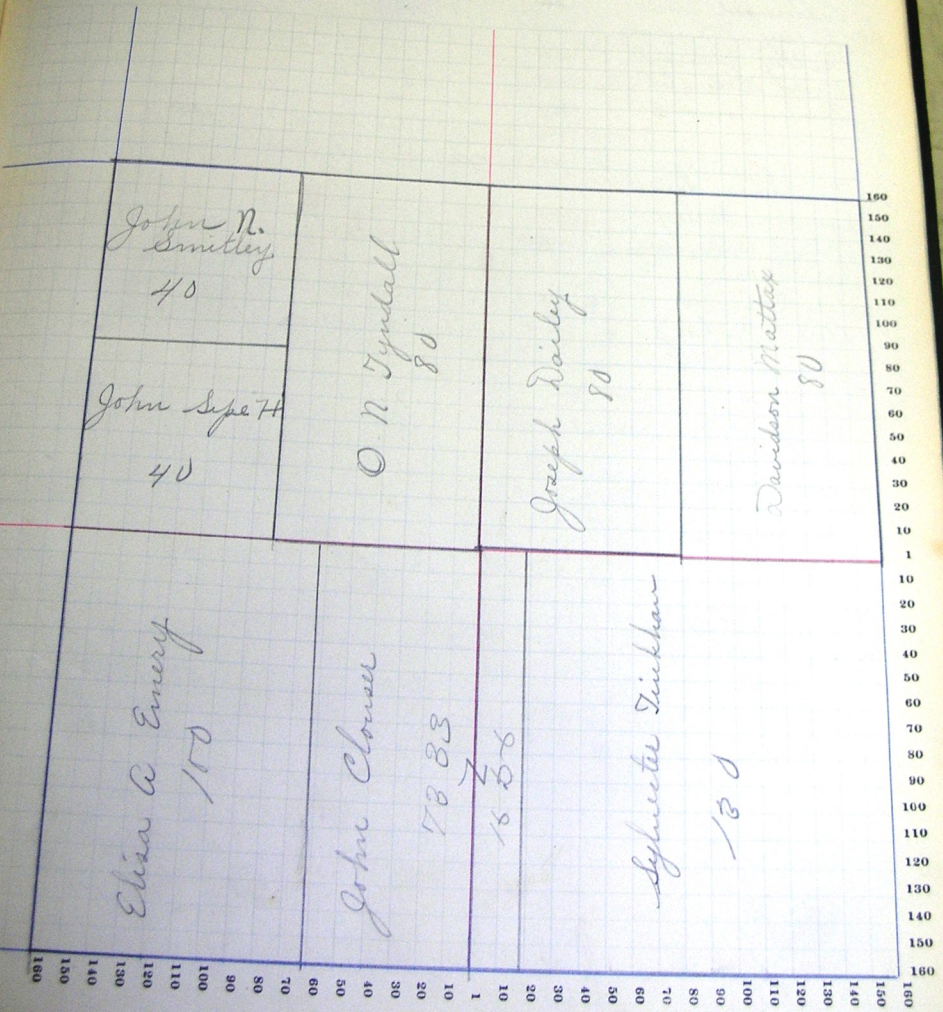

Adams

COUNTY, INDIANA, 1907.

Assessor's Plat-Book for Blue CreekTownship, No. 22

P. S. DODD, BLUE BOOK BLD. INDIANAPOLIS

NUMBERS OF PLOTS.	Number of Plots.	DESCRIPTION.	Section.	Township.	Range.	Acres.	Hundredths.	Value of Lands.	Value of Improvements.	Value of Lands and Improvements.
		Cross John	se	29	26	15	39	775'		
			nw	29			40	1080	80	
		Calderwood Geo. W.	sw	29			40	1080	80	
		Kelley Manerva	sw	29			40	1080	450	
		Kelley James	se	29			40	1150	400	
		Myers Betty et al	ne	29			80	2160	400	
		Bruden James K	1/2	29			80	7215'		
			1/2	29			40	1080		
			1/4 pt	29			40	1080	150	
		Tomblison Sarah	ne	29			40	1100	200	
		Vaughn Nancy	ne	29			38	501040	108	
		Vorhes Amanda	npt	29			1	5	41	
			ne cor	29			40	1080	500	
		Lipe John F.	se	29			40	1080		
		Burke John J	nw	29			40	1080		

SECTION No. 29

Congressional Township No. 26, R.

SCALE—Forty rods to an inch, or ten rods to a space, Congress Land, which is one mile square for a section.  
Number of acres in this section, according to the United States Survey.

				160 150 140 130 120 110 100 90 80 70 60 50 40 30 20 10 1 10 20 30 40 50 60 70 80 90 100 110 120 130 140 150 160
John J. Burke 40	Nancy Vaughn 40	Cross John 40	Sarah Jumbleson 40	
George W. Calderwood 40	James Kelley 40	Moneriva Kelley 40	John H Sipe 40	
James K Pruden 40		James K Pruden 80	Betty Myera 40	
Amanda Vorhees 40				
James K Pruden 70			John Cross 39	
160 150 140 130 120 110 100 90 80 70 60 50 40 30 20 10 1				

Value of  
Land and  
Improvements

Adams

Township, No. 24

Assessor's Plat-Book for Blue Creek

NAMES OF OWNERS.	Number on Plat.	DESCRIPTION.	Section.	Township.	Range.	Acres.	Hireholdths.	Value of Land.	Value of Improvements.	Value of Land and Improvements.
		sw	ne	30	26	15	40	1100	200	
Cyres Benjamin		sw	ne	30			40	1100	300	
Wagers John K.		1/2 1/2	se	30			150	3925	600	
Cyres Royal Etal		pt	nw	30			40	1100	400	
Clark Levi L.		nw	nw	30			35	963	200	
rs		sw		30			5	150		
rs		se cor sw	nw	30						
Griffith Thomas		pt 1/2	sw	30			57	1529	200	
Hartford Oil Co.		pt 1/2	se	30			10	270		
Miller Mathias		1/2 1/2	sw	30			80	2180	200	
Malony Joseph O.		nw	nw	30			40	1080	150	
Porter Andrew J.		nw	ne	30			40	1095	400	
Stauffer William		1/2 1/2	nw	30			20	550		
Stauffer Lydia		1/2 ne	nw	30			20	550		
Striker Finley		wood 1/2	nw	30			40	1100	250	
George Stone		se	nw	30			40	1100	250	
		pt 1/2	sw	30			23	621	100	

SECTION No. 30

Congressional Township No. 26, R.

SCALE—Forty rods to an inch, or ten rods to a space, Congress Land, which is one mile square for a section.  
 Number of acres in this section, according to the United States Survey, \_\_\_\_\_

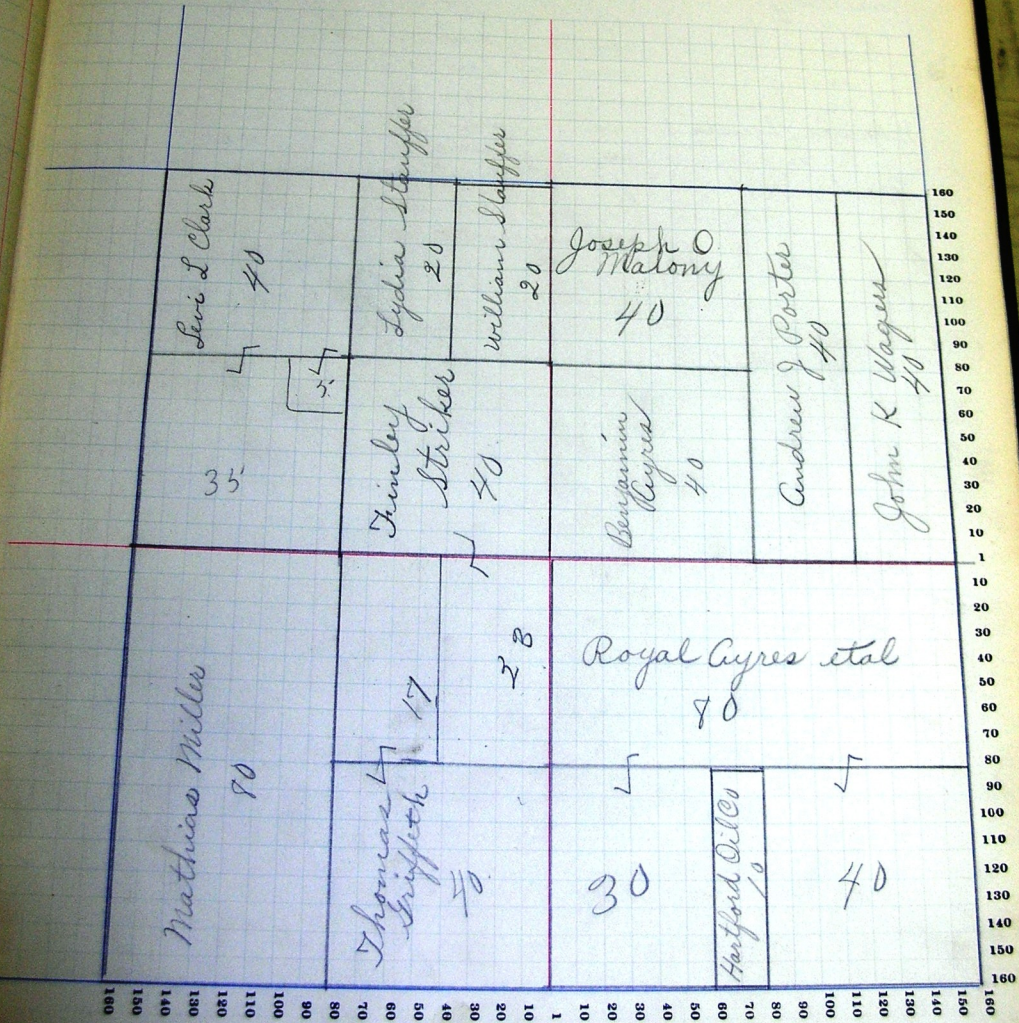



Adams

COUNTY, INDIANA, 1907.

Assessor's Plat-Book for

Blue Creek

Township, No. 26

PLAT BOOK FOR INDIANA

NAMES OF OWNERS.	Number on Plat.	DESCRIPTION.	Section.	Township.	Range.	Acres.	Hundredths.	Value of Land.	Value of Improvements.	Value of Land and Improvements.
Burdg Mark J.		$\frac{1}{2}$ $\frac{1}{2}$ ne	31	26	5	40		1070	400	
Burdg Maggie C.		$\frac{1}{2}$ $\frac{1}{2}$ ne	31			40		1080		
Jones Mary		nw	31			80		1875	300	
do		$\frac{1}{2}$ nw	31			40		1000		
do		sw	31			10		250		
do		nw nw sw	31			5		125		
do		nw sw	31			160		4320	500	
Morrison Elizabeth		ne	31			80		1720		
do		$\frac{1}{2}$ ne	31			145		3735	500	
Rawley Jacob		pt sw	31							

SECTION No. 31

Congressional Township No. 26, R.

SCALE—Forty rods to an inch, or ten rods to a space, Congress Land, which is one mile square for a section.  
Number of acres in this section, according to the United States Survey,

Value of Improvements.  
Value of Land and Improvements.

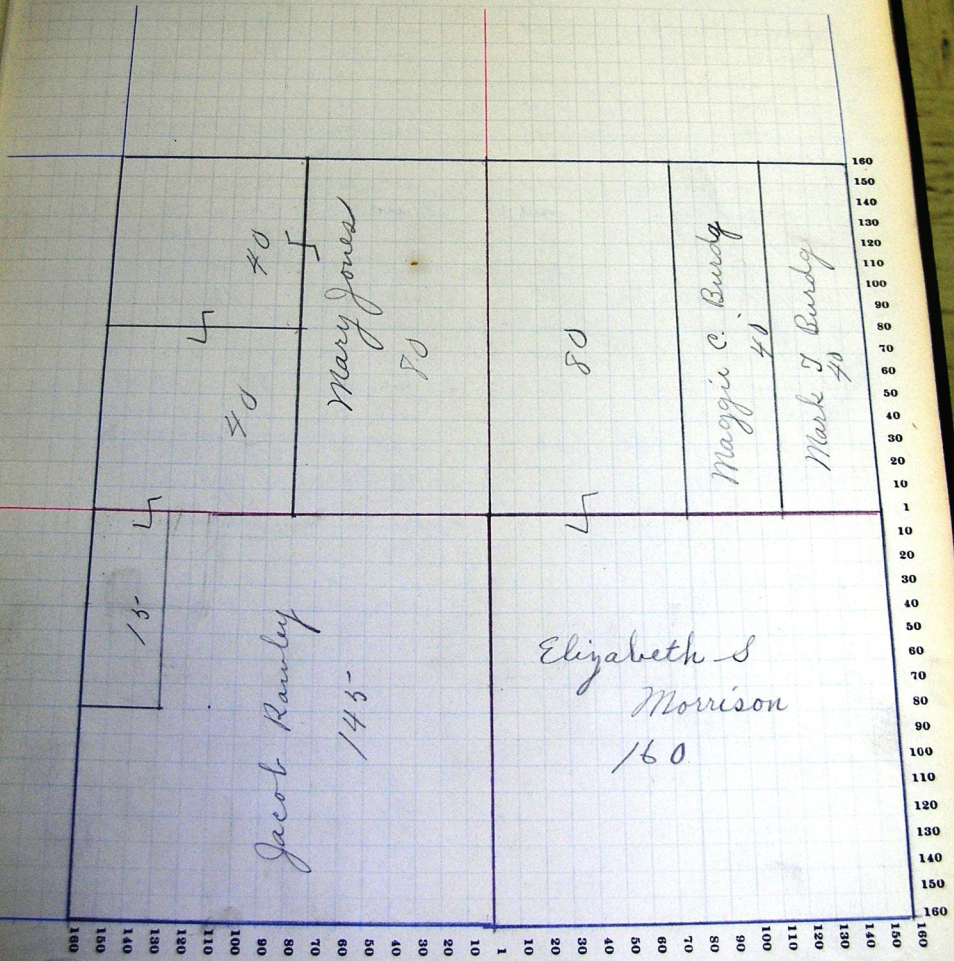

NAMES OF OWNERS.	Number of Plats.	DESCRIPTION.	Section Township Range.	Acres.	Hundredths.	Value of Land.	Value of Improvements.	Value of Land and Improvements.
Cross John		w <sub>2</sub> ne	32 26 15	80		2160	450	
Cigler Samantha		w <sub>2</sub> ne sec	32	20		576		
oo		pt sw	32	30		825	200	
Cotterell Maggie C.		pt w <sub>2</sub> nw	32	82		864	200	
Evans Bertha		pt sw	32	350		95	80	
Frank John		se ne	32	40		1000		
oo		pt w <sub>2</sub> sw	32	44		1210	800	
oo		npt e <sub>2</sub> se	32	32		800		
oo		npt w <sub>2</sub> sw	32	18		486	150	
oo		e <sub>2</sub> ne ne	32	20		500		
Foreman Iida M.		mid pt e <sub>2</sub> se	32	32		864		
Foreman Edward		mid pt sw	32	72		1944	800	
Gregory Lucy J.		mid pt nw	32	80		2000	400	
Habegger Peter E.		w <sub>2</sub> nw	32	47	50	1222		
oo		pt e <sub>2</sub> nw	32	1	15	30	60	
McAlexander Hettie May		pt sw	32	16		440	200	
Parr Bertram		spt e <sub>2</sub> se	32	42		1155	200	
Parr John M.		sw cor sw	32	80		2160	500	
Sipe Andrew J.		w <sub>2</sub> se	32	7		185	100	
Ruyon Lydia A.		pt sw	32	3	50	95	80	
Stein Grace m & Philip		pt sw	32			53	15	50
Wagner H L.		pt sw	32					



ADAMS COUNTY, INDIANA, 1907.

Assessor's Plat-Book for

Blue Creek

Township, No. 25

NAMES OF OWNERS.	Number on Plat.	DESCRIPTION.	Section.	Township Range.	Acres.	Hundredths.	Value of Land.	Value of Improvements.	Value of Labor and Material Expended.
Foreman Edward		npt $w\frac{1}{2}$ sw	33	26 1/4 18	486	400			
Foreman W. L.		$\frac{1}{2}$ $w\frac{1}{2}$ nw	33		40	1500	300		
Kiefer Samuel		nw	33		40	1500	150		
Wilson Chas A		$e\frac{1}{2}$ ne nw	33		20	540			
Foreman James		$e\frac{1}{2}$ sw	33		90	2040	600		
oo		$w\frac{1}{2}$ se nw	33		20	520			
oo		$\frac{1}{2}$ se nw	33		20	520	40		
Parr W. H.		$\frac{1}{2}$ se	33		160	4400	600		
oo		se ne	33		40	1150			
Sipe Joseph L.		ne ne	33		40	1150	200		
oo		$w\frac{1}{2}$ ne	33		80	2200	700		
Speakman W. L.		$w\frac{1}{2}$ ne nw	33		20	540	50		
Frank John		pt $w\frac{1}{2}$ sw	33		44	1210	350		
oo		npt $w\frac{1}{2}$ sw	33		18	486	150		



Adams

COUNTY, INDIANA, 1907.

Assessor's Plat-Book for Blue Creek

Township, No. 26

NAMES OF OWNERS.	Number of Plat.	DESCRIPTION.	Section.	Township.	Range.	Acres.	Headlands.	Value of Land.	Value of Improvements.	Total Value.
Sipe Andrew J.		pt nw	34	26	13	106	67	2592		
Sipe Joseph L.		nw	34			48	1100	50		
do		pt ne	34			53	38	1450	150	
Polambougher Abe		pt se	34			109		2997	600	
do		upt se	34			57		1934		
Sipe John H.		spt sw	34			70		1960	450	
Smalley W. M.		pt n <sub>2</sub> sw	34			30		824		
do		pt n <sub>2</sub> sw	34			10		275		
Tinkham W. J.		w <sub>2</sub> ne	34			20		550	700	
do		se	34			40		1100		
do		s <sub>2</sub> ne	34			20		550	150	
Tinkham Frances M.		pt n <sub>2</sub> <del>sw</del>	34			40		1100	500	
Vogt Jacob		sw	34			40		1100	100	

SECTION No. 34

Congressional Township No. 26, R.

SCALE—Forty rods to an inch, or ten rods to a space, Congress Land, which is one mile square for a section. Number of acres in this section, according to the United States Survey.

Value of Land.	Value of Improvements.	Value of Land and Improvements.
592		
50	30	
130		
600		
450		
700		
50		
100		
70		

