

Adam

COUNTY, INDIANA, 1925

Assessor's Plat-Book for

French.

Township No. 26

PTG. CO. FT. WAYNE, IND.

NAMES OF OWNERS	Number on Plat	DESCRIPTION	Section	Township	Range	Acres	Hundredths	Value of Lands	Value of Improvements	Value of Lands and Improvements
Rich Ewert O	1	NW NW	13	R6	13	40		3200		3200
Eckhart Julius	2	NE NW	"	"	"	40		3240		3240
French Wm	3	W/2 NE	"	"	"	80		6560		
Do	4	1/2 S/2 NE	"	"	"	59	96	4790	1200	12550
Graber Henry P.	5	NE SE.	"	"	"	40		3400		
Do	6	1/2 S/2 NE	"	"	"	20		1700		
Do	7	1/2 S/2 NE	"	"	"		04	10		5710
Meyer Henry A	8	W/2 SW	"	"	"	80		6400	950	7350
Amstutz John	9	E/2 SW	"	"	"	80		6600	1250	7850
Newbauer Jacob J	10	W/2 SE	"	"	"	80				
Morhamm Abdan	11	SE SE	"	"	"	40		3240	200	3440
Rich John	12	S/2 NW	"	"	"	80		6480	1750	8230

SECTION No. 13

Congressional Township No. 26, R. 13

E. Forty rods to an inch, or ten rods to a space, Congress Land, which is one mile square for a section.
er of acres in this section, according to United States Survey, _____

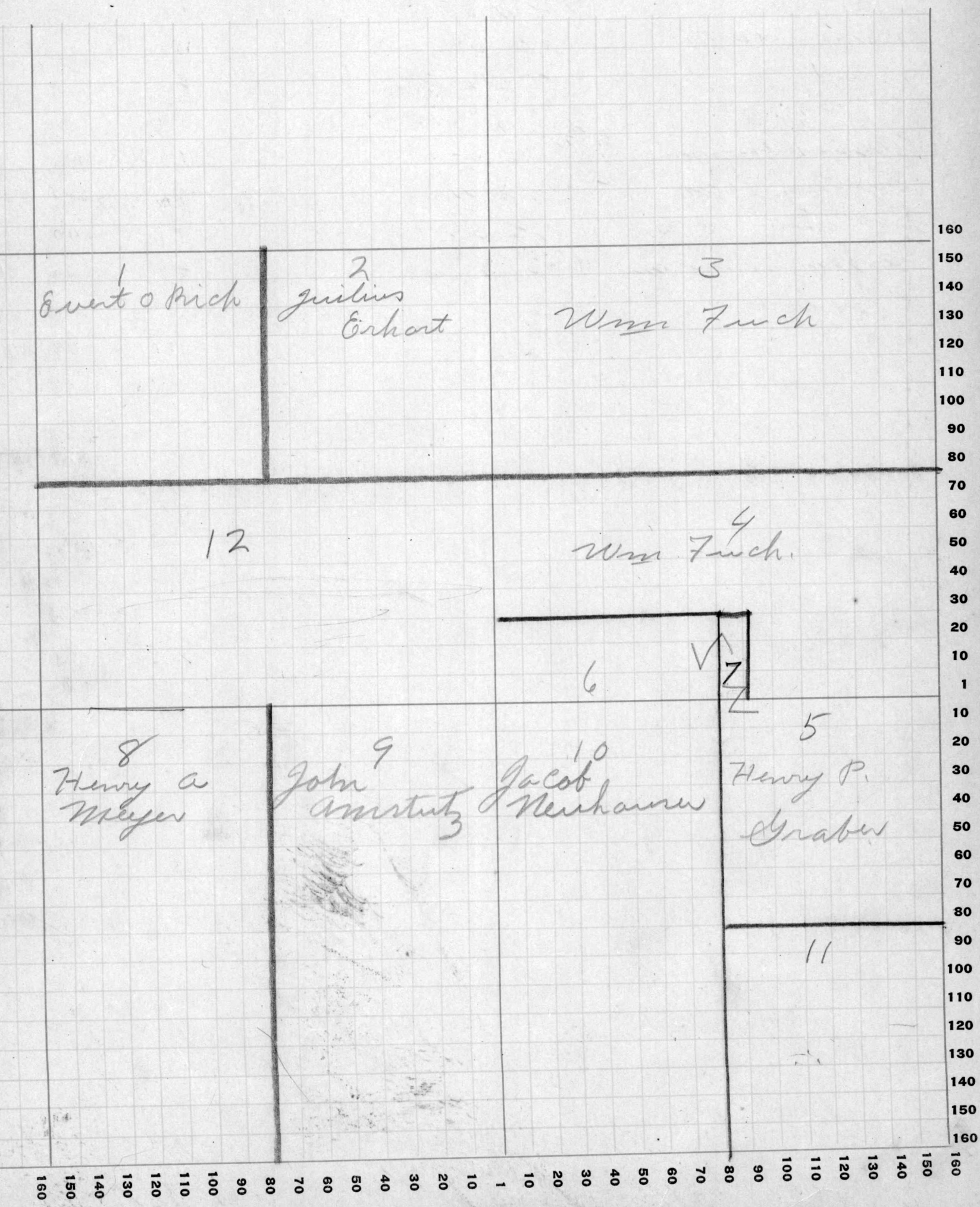

Assessor's Plat-Book for French

Township No. 26

NAMES OF OWNERS	Number on Plat	DESCRIPTION	Section	Township	Range	Acres	Hundredths	Value of Lands	Value of Improvements	Value of Lands and Improvements
		Forest Reserve				5		15		
Gerber Benj.	1	1/2 SW NW	14	26	13	15		375		390
Kiffer Ephraim	2	1/2 W/2 NE	"	"	"	40		3240	1550	
Do	3	SW NE	"	"	"	40		3240		
Do	4	NW SE	"	"	"	40		3240		11270
Kahler Alfred	5	1/2 NW	"	"	"	80		6480	1550	8030
Klickman Augusta	6	1/2 NE	"	"	"	80		6440	800	7240
Liechty Joseph & Martha	7	1/2 SE	"	"	"	80		6380	1500	7880
Neun Schwander Eli	8	SW	"	"	"	160		13100	1650	14750
Bingger Jacob	9	1/4 W/2 NW	"	"	"	59	50	4660	700	
Do	10	1/4 W/2 NW	"	"	"		50	40		5400
Siequist Samuel	11	NE SE	"	"	"	40		3240		3240

SECTION No. 14

Congressional Township No. 26, R. 13

SCALE: Forty rods to an inch, or ten rods to a space, Congress Land, which is one mile square for a section.
Number of acres in this section, according to United States Survey, _____

