

Adams

COUNTY, INDIANA, 1925

Assessor's Plat-Book for French

Township No. 26

CO. FT. WAYNE, IND.

NAMES OF OWNERS	Number on Plat	DESCRIPTION	Section	Township	Range	Acres	Hundredths	Value of Lands	Value of Improvements	Value of Lands and Improvements
Bachler John	1	1/2 NW	21	26	13	17	42	1000		1000
Baumgartner Joel	2	NE SE	"	"	"	40		1420		1420
Baumgartner Sam	3	1/2 NE NE	"	"	"	6		230		230
Baumgartner Mary	4	1/2 NE NE	"	"	"	7		280		280
Baumgartner Louis	5	SE SE	"	"	"	40		2200		2200
Spichiger David	6	1/2 SW SE	"	"	"	5	73	190		190
Kipper John	7	1/2 NW SE	"	"	"	14		560		
Do	8	1/2 NE NE	"	"	"	16		1040		
Do	9	1/2 NW NE	"	"	"	20		720		
Do	10	1/2 SW NE	"	"	"	9		270		2590
Kipper Wm	11	1/2 SE NE	"	"	"	30		970		970
Uehmann Abe	12	1/2 SE SW	"	"	"	18	50	560		
Do	13	1/2 NW	"	"	"	80		2560	1000	
Do	14	1/2 1/2 NW	"	"	"	35	46	1200		5320
Lobsiger John	15	1/2 NW NE	"	"	"	9	25	280		
Do	16	1/2 NW SW	"	"	"	63		4030	1200	
Do	17	1/2 SE NW	"	"	"	10	60	320		
Do	18	NE SW	"	"	"	40		1500		
Do	19	NW SE	"	"	"	40		1500		8830
Minger John J.	20	1/2 NW NE	"	"	"	4		240	950	1210
Reinhart Fred C.	21	SW SE	"	"	"	40		2400	1050	3450
Reinhart Fanny Etal	22	SE SW	"	"	"	48		2880		2880
Schwarz John J.	23	1/2 NE NE	"	"	"	5		150		
Do	24	1/2 NE NE	"	"	"	6		150		
Do	25	1/2 1/2 NE	"	"	"	15	06	520		
Do	26	1/2 1/2 NE	"	"	"	10		350		1170

SECTION No. 21

Congressional Township No. 26, R. 13

Scale: Forty rods to an inch, or ten rods to a space, Congress Land, which is one mile square for a section.
 Number of acres in this section, according to United States Survey, _____

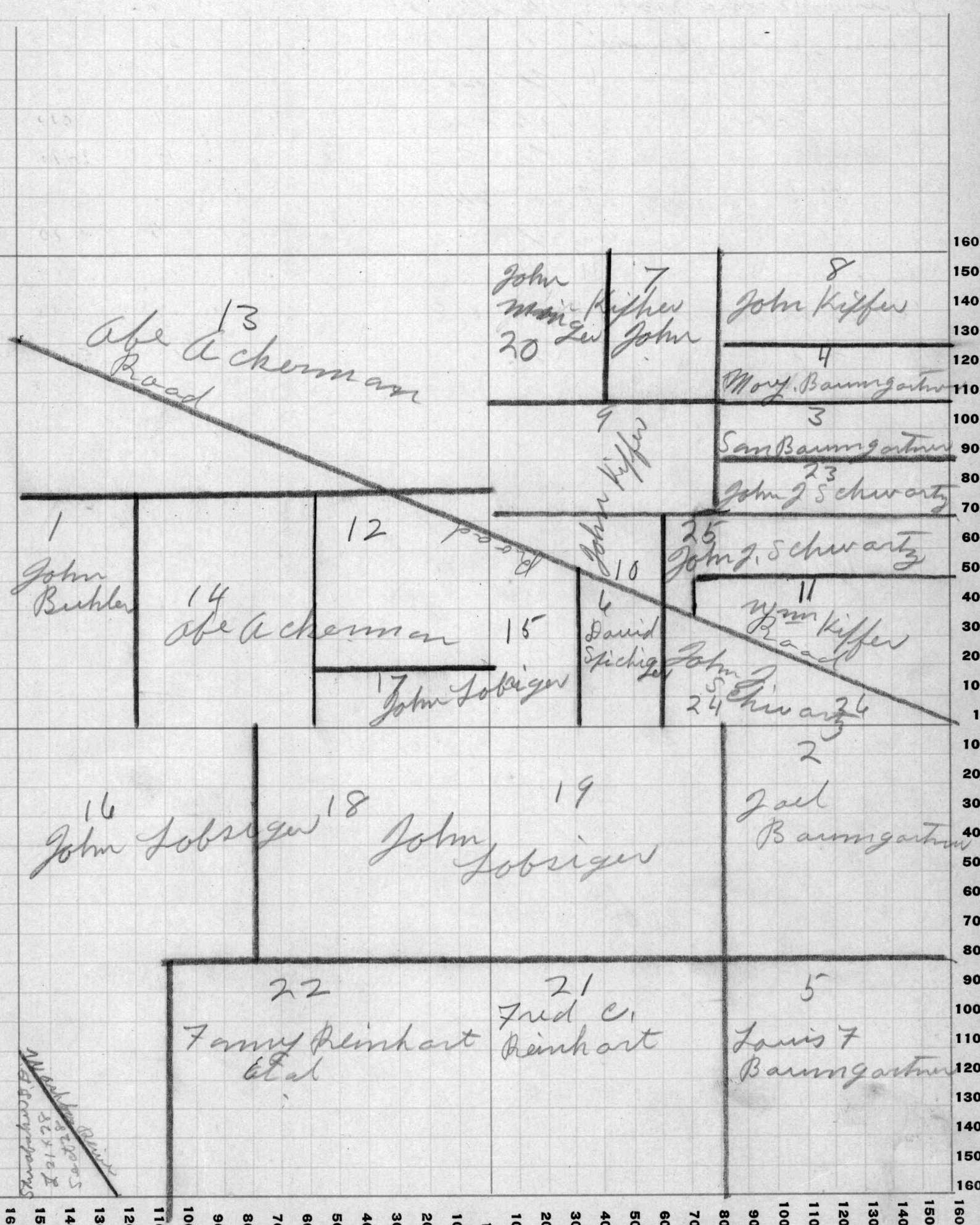

Adams

COUNTY, INDIANA, 1925

Assessor's Plat-Book for French

Township No. 24

NAMES OF OWNERS	Number on Plat	DESCRIPTION	Section	Township	Range	Acres	Hundredths	Value of Lands	Value of Improvements	Value of Lands and Improvements
Baumgartner Joel	1	1/2 NW	22	24	13	40		2200	1650	
Do	2	1/2 SW NW	"	"	"	20		800		
Do	3	1/2 NW	"	"	"	20		700		5350
Baumgartner Sam	4	1/2 NE	"	"	"	10		700		700
Baumgartner Mary	5	1/2 NE	"	"	"	20		450		
Do	6	1/2 SW	"	"	"	15		700		
Do	7	1/2 NW	"	"	"	80		4000	1500	6650
Baumgartner Joseph	8	1/2 NE	"	"	"	45		3240		3240
Zirkle Thea Bond Coy	9	1/2 SW	"	"	"	64		2500	150	2650
Ladd Boyd	10	1/2 SE	"	"	"	79	50	3580	1550	5131
Moser Daniel D	11	1/2 SE	"	"	"	75		4500	850	5350
Reinhart Daniel D	12	1/2 NE	"	"	"	76		4260	1350	5630
Sheets Noah J	13	1/2 SW	"	"	"	76		4460	1300	5760

SECTION No. 22

Congressional Township No. 26, R. 13

E: Forty rods to an inch, or ten rods to a space, Congress Land, which is one mile square for a section.
er of acres in this section, according to United States Survey, _____

