

Scale—Forty rods to an inch, or ten rods to a space, Congress Land, which is one mile square for a section.
 Number of acres in this section, according to the United States Survey, _____

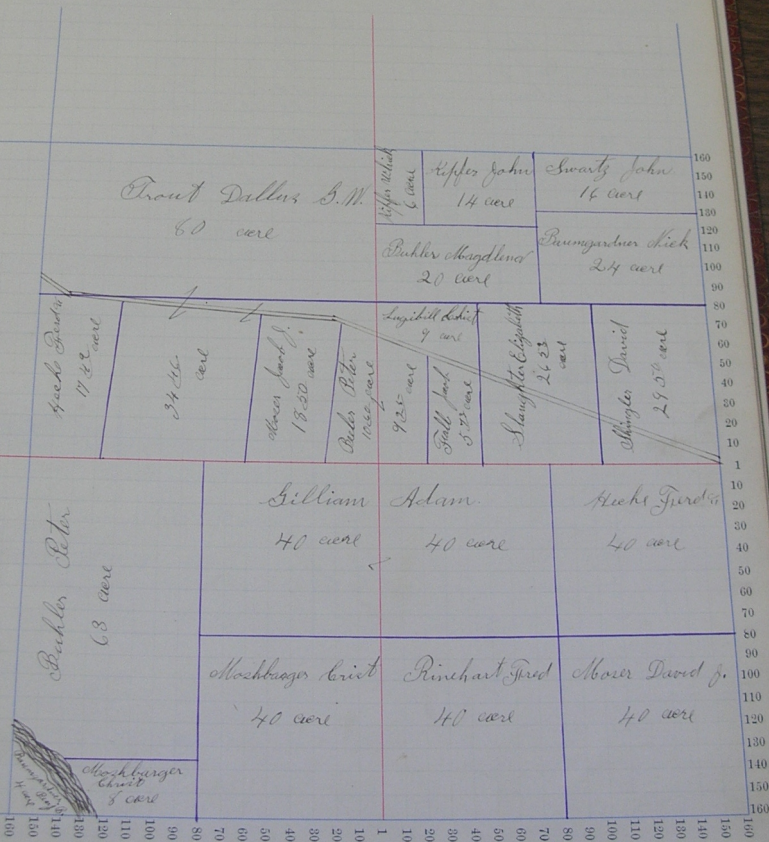

Scale—Forty rods to an inch, or ten rods to a space, Congress Land, which is one mile square for a section.
Number of acres in this section, according to the United States Survey, _____

Reppert Frederick J.
133 1/2 acre

Baumgardner disk
30 acre

20 acre

Biberstein Abt
12 1/2 acre

Baumgartner Nierena
64 acre

Biberstein Abt
15 acre

ebberer Amad
75 acre

Amstutz Christian
75 1/2 acre

Moser David J.
76 acre

160
150
140
130
120
110
100
90
80
70
60
50
40
30
20
10
1
10
20
30
40
50
60
70
80
90
100
110
120
130
140
150
160

160
150
140
130
120
110
100
90
80
70
60
50
40
30
20
10
1

Scale—Forty rods to an inch, or ten rods to a space, Congress Land, which is one mile square for a section.
Number of acres in this section, according to the United States Survey, _____

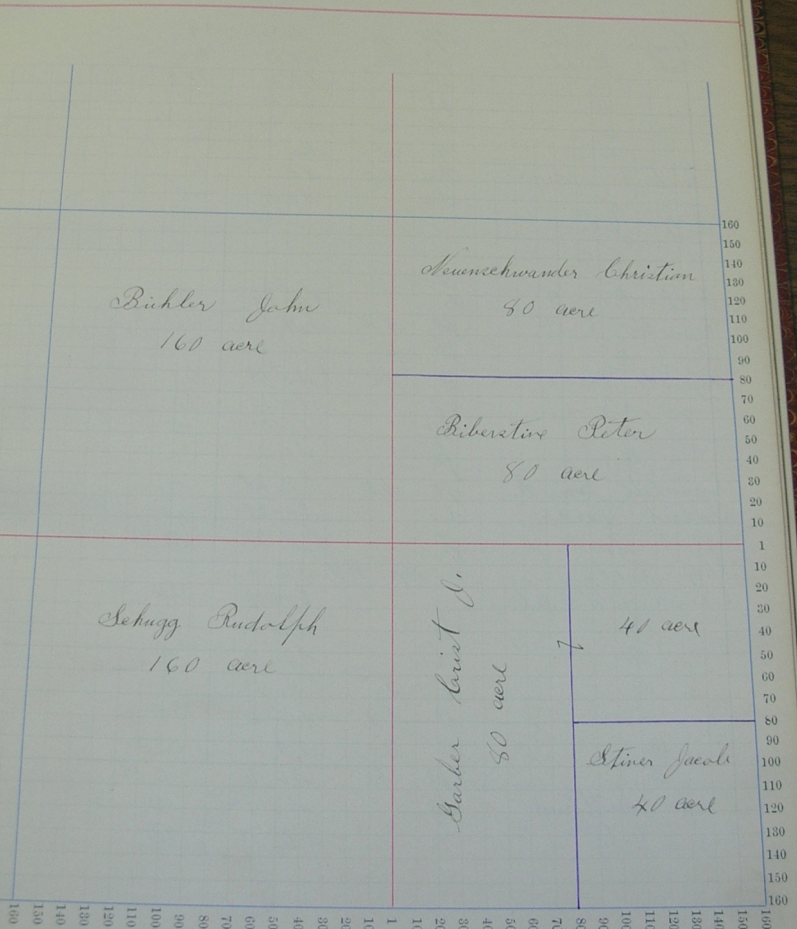

Scale—Forty rods to an inch, or ten rods to a space, Congress Land, which is one mile square for a section.
Number of acres in this section, according to the United States Survey, _____

Rich Joseph
50 acre

Both Peter D
80 acre

Molman Jacob
80 acre

Brocker Jacob Jr.
80 acre

Rich Joseph
80 acre

Molman Jacob
80 acre

20 acre

Stiner Jacob
60 acre

Moser Peter F.
80 acre

160
150
140
130
120
110
100
90
80
70
60
50
40
30
20
10
1
10
20
30
40
50
60
70
80
90
100
110
120
130
140
150
160

160
150
140
130
120
110
100
90
80
70
60
50
40
30
20
10
1

Section No. 25

Congressional Township No. 26, R. 12

Scale—Forty rods to an inch, or ten rods to a space, Congress Land, which is one mile square for a section.
Number of acres in this section, according to the United States Survey.

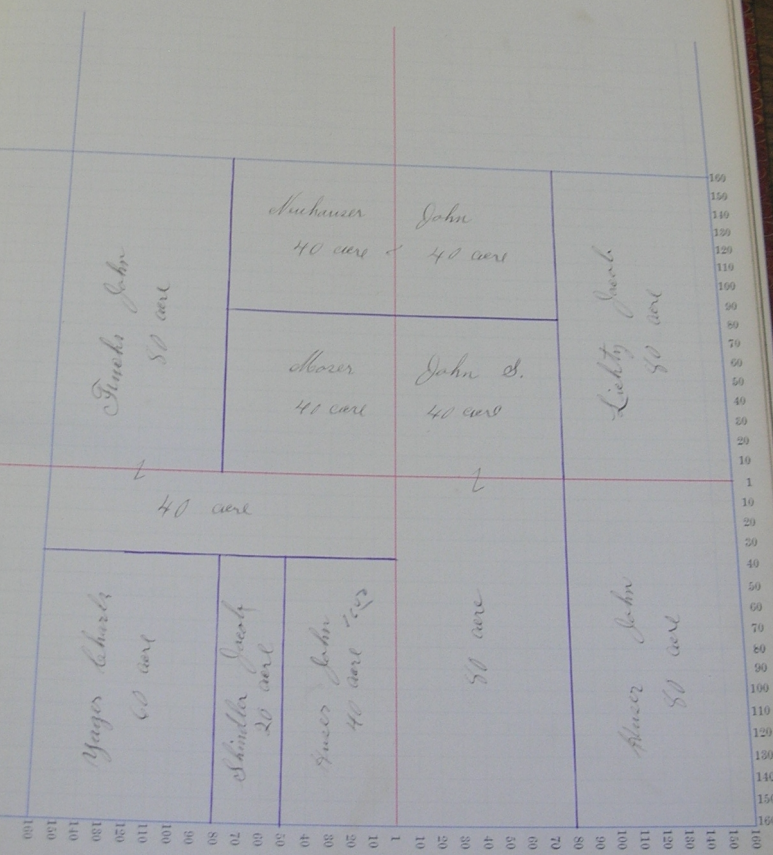

Scale—Forty rods to an inch, or ten rods to a space, Congress Land, which is one mile square for a section.
Number of acres in this section, according to the United States Survey, _____

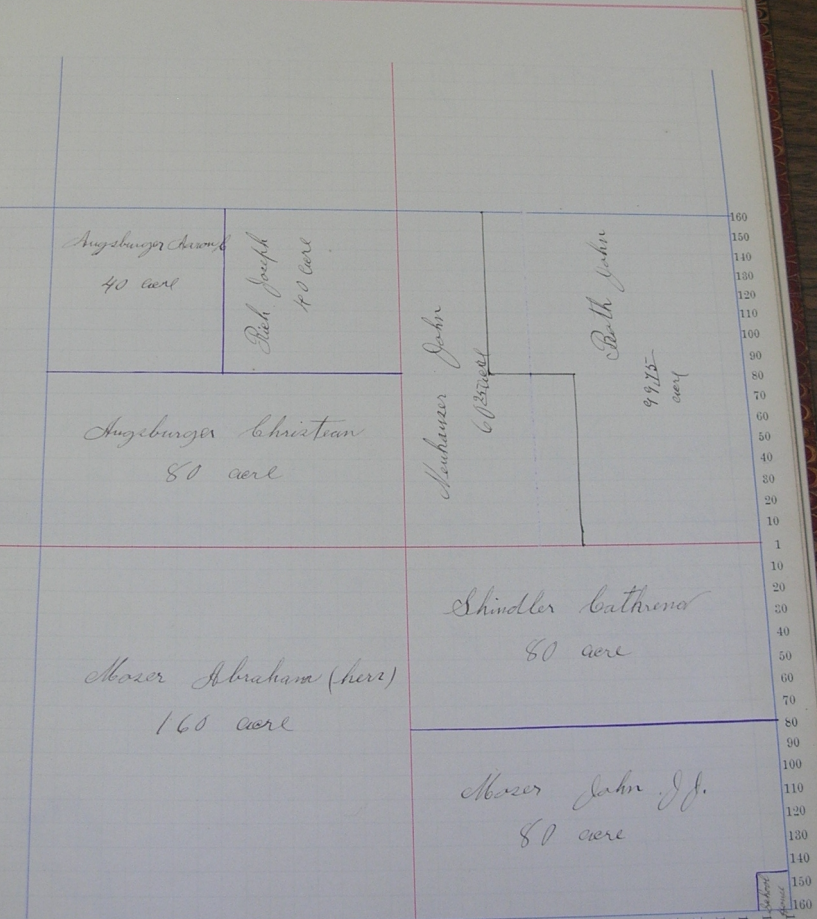

Augsburger August
40 acre

Dieck Joseph
40 acre

Augsburger Christian
80 acre

Moser Abraham (heir)
160 acre

Neubauer John
60 acre

Beath John
99.75
acre

Schindler Catharina
80 acre

Moser John J.
80 acre

160
150
140
130
120
110
100
90
80
70
60
50
40
30
20
10
1
10
20
30
40
50
60
70
80
90
100
110
120
130
140
150
160

Section
Number

Section No. 27

Congressional Township No. 26, R. 13

Scale—Forty rods to an inch, or ten rods to a space, Congress Land, which is one mile square for a section.
Number of acres in this section, according to the United States Survey, _____

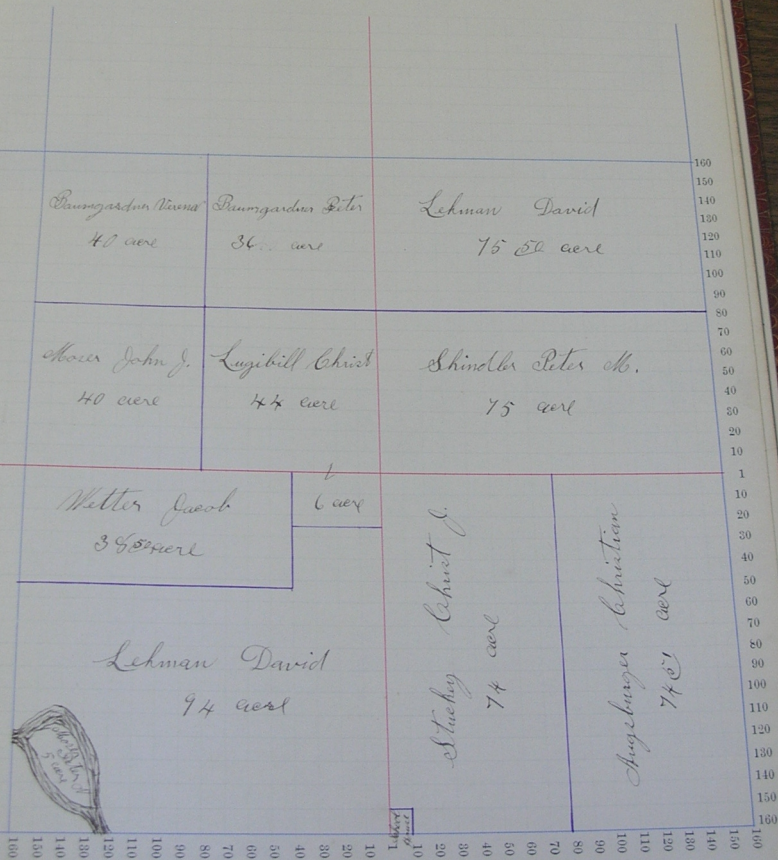

Scale—Forty rods to an inch, or ten rods to a space, Congress Land, which is one mile square for a section.
Number of acres in this section, according to the United States Survey.

