

Adams

Hartford

Township, No.

Assessor's Plat-Book for

NAME OF OWNER.	Section No.	DESCRIPTION.	Acres.	Value of Land.	Value of Improvements.	Value of Land and Improvements.
Jeff Henry J.	1	NE NW	21 25 12 40	1200		
Mumfink Sarah L	2	SE 1/2 NE		40		390
Mumfink Catharine	3	SE 1/2 NE		20		580
Mumfink John	4	N E NE		40		1300
Mumfink Francis	5	SE 1/2 NE		20		690
"	6	SE SE NW		1		60
"	7	W 1/2 SE		80		2520
Bears Lemuel C	8	SE 1/2 SE		20		620
"	9	E 1/2 NE SW		20		620
Pieble Lucy J.	10	E 1/2 SE SW		20		590
"	11	SE SE NW		2	99	90
"	12	W 1/2 NE SW		20		620
Snyder Martha	13	SE SE NW		13 25		450
"	14	N 1/2 W 1/2 NW		10		340
"	15	E 1/2 SW SW		20		640
Cooper Geo W	16	W 1/2 SE SW		20		620
Clendenen Ester	17	N W SW		40		1260
Snyder Geo	18	W 1/2 SW SW		20		690
"	19	SE SE NW		23 25		750
"	20	W 1/2 NW		70		2330
Snyder Mary W	21	SE 1/2 SE		60		1770
Bears Phoe B	22	N W NE		40		1220
Ruffs Emanuel						150

SECTION No. 21

Congressional Township No. 25, R. 13

SCALE: Forty rods to an inch, or ten rods to a space, Congress Land, which is one mile square for a section  
 Number of acres in this section, according to the United States Survey. 629 3/4

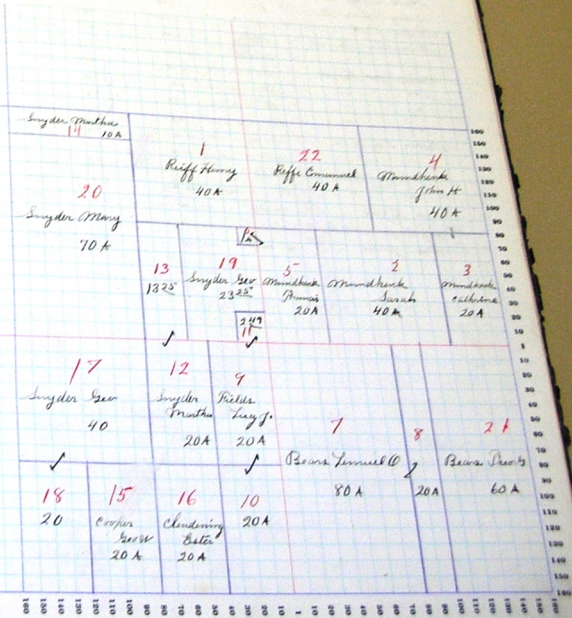

Adams

Township, No.

Assessor's Plat-Book for

Hartford

NAMES OF OWNERS	Number of Pts.	DESCRIPTION.	Section	Township	Range	Acres	Value of Land.	Value of Improvements.	Value of Land and Improvements.
			22	25	13	20	590	190	
Dwyler Mary C	1	pt sw				43	76	1270	190
Hall Eddy S	2	pt sw				40		960	
Lindsay Rufina B	3	pt sw				16		460	
Bieble P L	4	pt sw				40		1150	
Shromaker John P	5	pt sw				75	83	2050	560
" " "	6	n/2 se				19			
Watson Jot Geo. St.	7	pt e/2 se				19			
" " "	8	pt e/2 se				19			
" " "	9	pt e/2 se				21	48	2300	360
" " "	10	pt e/2 se				40		1300	900
Moser Elizabeth	11	sw ne				10		320	
" " "	12	n/4 a se ne				79	20	2560	
" " "	13	n/2 ne				29	25	970	
" Solomon Huns	14	pt se ne				78	83	2500	300
" " "	15	n/2 nw				40		1300	450
Bugh Ezra	16	se nw				40		1120	
Lindsay Eugene & R B	17	sw nw							

SECTION No. 22

Congressional Township No. 25, R. 13

SCALE: Forty rods to an inch, or ten rods to a space, Congress Land, which is one mile square for a section  
Number of acres in this section, according to the United States Survey, 621 7/10

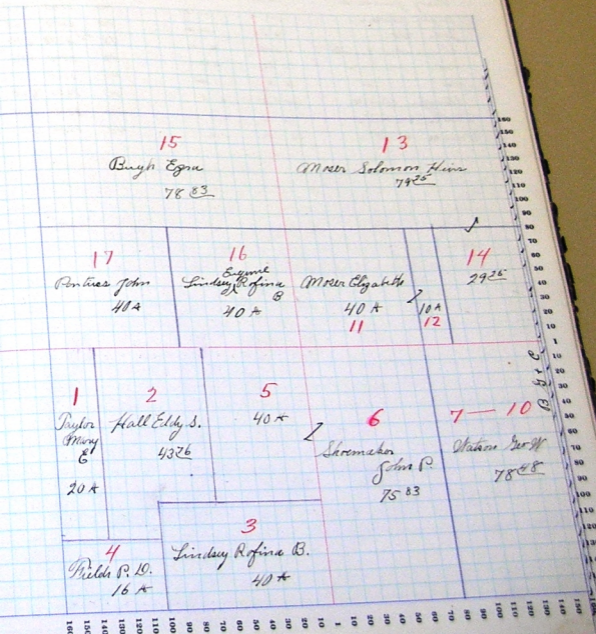



SECTION No. 23

Congressional Township No. 25, R. 13

SCALE: Forty rods to an inch, or ten rods to a space, Congress Land, which is one mile square for a section.  
 Number of acres in this section, according to the United States Survey,  $636 \frac{48}{100}$

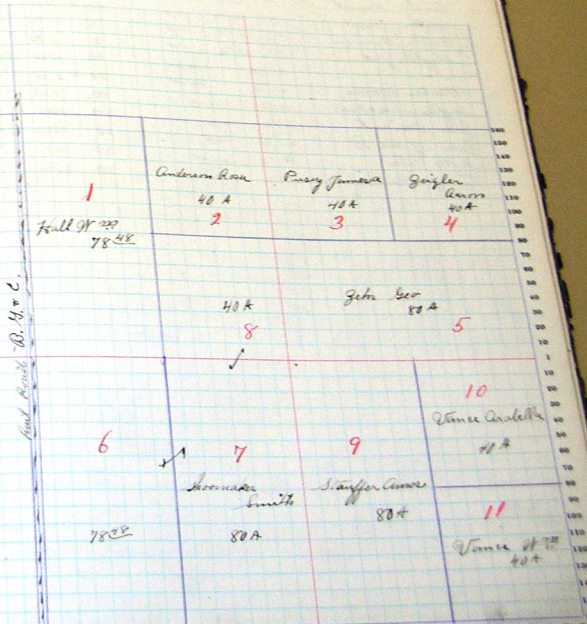

## COUNTY, INDIANA, 1911

Address \_\_\_\_\_

Township, No. \_\_\_\_\_

Assessor's Plat-Book for

Hartford

NAMES OF OWNERS.	Number on Plat.	DESCRIPTION.		Section.	Township.	Range.	Acres.	Value of Lands.	Value of Improvements.	Value of Lands and Improvements.
Zeigler Aaron	1	nw	nw	14	16	13	39	1260	300	
Stanley Solomon	2	pt s/2	se				18 75	610	300	
Lichtig Daniel	3	w s/2	ne				9 14	290	190	
Müller Sarah	4	pt s/2	ne				34 30	1130	340	
Müller Emma	5	pt s/2	ne				8	270	50	
Shuffler Joel	6	pt s/2	ne				9	290		
" "	7	n e	nw				40	1260	200	
Martin Motors	8	s/2	nw				79 65	2560	350	
Shuffler Anna & Kate	9	n/2	ne				80	2680	600	
Zehr Michael	10	e/2	se				80	2700	600	
Zehr John B	11	s/2	se				80	2680	950	
Roth Peter	12	n/2	sw				80	2640	750	
Lichtig Peter	13	s/2	sw				80	2680	320	

SECTION No. 21

Congressional Township No. 25, R. 13

SCALE: Forty rods to an inch, or ten rods to a space, Congress Land, which is one mile square for a section.  
 Number of acres in this section, according to the United States Survey, 637 <sup>77</sup>/<sub>100</sub>

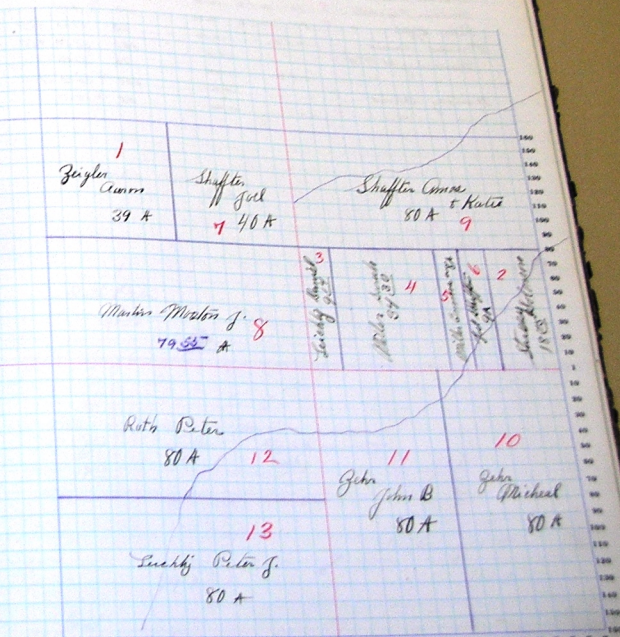

1081  
1082  
1083  
1084  
1085  
1086  
1087  
1088  
1089  
1090  
1091  
1092  
1093  
1094  
1095  
1096  
1097  
1098  
1099  
1100  
1101  
1102  
1103  
1104  
1105  
1106  
1107  
1108  
1109  
1110  
1111  
1112  
1113  
1114  
1115  
1116  
1117  
1118  
1119  
1120