

County, Indiana, 1880.

Assessor's Plat-Book for _____

Township, No. _____

NAMES OF OWNERS.	Number on Plat.	DESCRIPTION.		Section.	Township.	Range.	Acres.	Hundredths.	Value of Lands.	Value of Improvements.	Value of Lands and Improvements.
					7	25	15				
Abriet John	4	W 1/2	SE	7	2.	"	80		490	40	530
Cook Sarah E.	2	W 3/4	SW	"	"	"	59	33	350	50	400
Kumler Michael	3		NW	"	"	"	160		1100		1100
Lombaugh Emily	4	W 1/4	NE	"	"	"	106	67	650		650
Jones Hugh B.	5	E 1/4	NE	"	"	"	59	33	320		320
Macey Thos E	6		SW	"	"	"	80		500	85	585
Stump & Williams	7	E 1/2	SE	"	"	"	80		520	15	535
Rumple John	8	SE	SW	"	"	"	26	64	170	40	210

Section No. 7

Congressional Township No. , N., R. E.

SCALE:— Forty rods to an inch, or ten rods to a space, Congress Land, which is one mile square for a section.
Number of acres in this section according to the UNITED STATES Survey

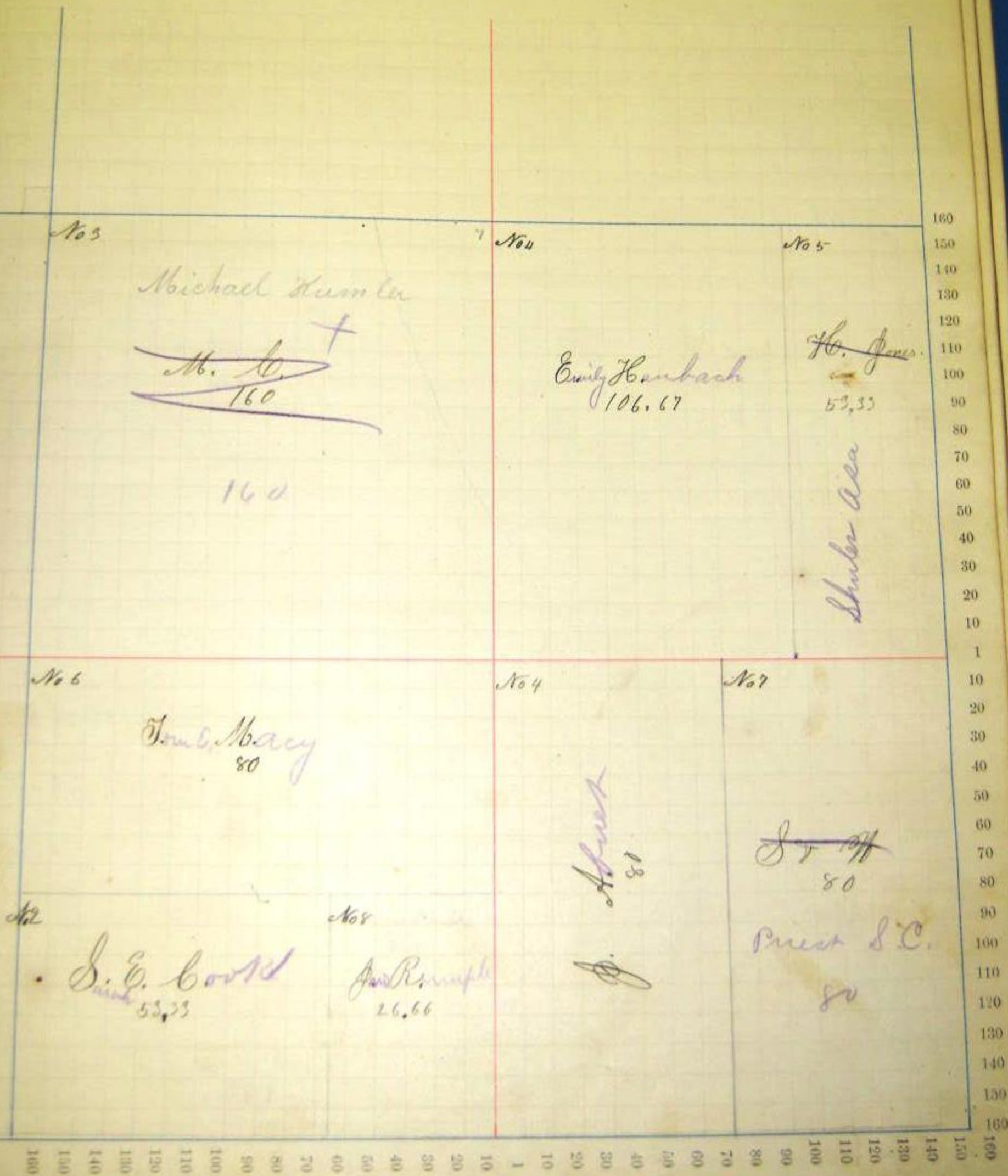

County, Indiana, 1880.

Assessor's Plat-Book for

Township, No. _____

NAMES OF OWNERS.	Number on Plat.	DESCRIPTION.	Section.	Township.	Range.	Acres.	Hundredths.	Value of Lands.	Value of Improvements.	Value of Lands and Improvements.
Jones Hugh	1		NW	8	25	15	160	960		960
Eyer D. S.	2	Wpt NW	NE	"	"	"	48	290		290
Rumple Jacob	3		SW	"	"	"	160	960	60	1020
Rean Wm	4	NE	NE	"	"	"	40	250		250
King Wm	5	Pt SW	NE	"	"	"	32	200		200
Marshall Laura J	6	SE	NE	"	"	"	40	250		250
Trout Wm	7	W 1/2	SE	"	"	"	80	490		490
Claypool Felix	8	NE	SE	"	"	"	40	250		250
Stump & Wickham	9	SE	SE	"	"	"	40	250		250

Section No. 8

Congressional Township No. _____, N., R. _____ E.

SCALE:—Forty rods to an inch, or ten rods to a space, Congress Land, which is one mile square for a section.
Number of acres in this section according to the UNITED STATES SURVEY.

No 1

Shuler Asa
160 acres
~~H. J. 160~~

No 2

~~J. S. E.~~
48
J. D. Tyler
Lutter John P.

No 4

W. R.
40
Harden John

No 5

Wm King
32
+

No 6

~~L. J. M.~~
40

No 3

Knepper Jacob F.
~~J. R.~~
160 ~~102~~ acres

No 7

W. S.
30
Dont Desm

8

~~F. G.~~
40

Rumple Jacob
50 acres

No 8

~~J. W.~~
40

Print S. C.
50 acres

160 150 140 130 120 110 100 90 80 70 60 50 40 30 20 10 1 10 20 30 40 50 60 70 80 90 100 110 120 130 140 150 160

County, Indiana, 1880.

Assessor's Plat-Book for

Township, No. _____

NAMES OF OWNERS.	Number on Plat.	DESCRIPTION.	Section.	Township.	Range.	Acres.	Hundredths.	Value of Lands.	Value of Improvements.	Value of Lands and Improvements.
Eppingen Wm P	1	N $\frac{1}{2}$	NW 9	25	15	80		478	110	585
Kumler Michael	2	S $\frac{1}{2}$	NW	"	"	80		525		525
Moser John	3	Pt	NE	"	"	160		1050		1050
Borlow Jacob	4	Pt	SW	"	"	142	23	750	205	955
Borlow Wm	20	Und $\frac{1}{3}$	SW	"	"	17	77	105	20	
21	20	" "	SW	"	"	17	77	105	30	270
Kribarger Wm P	5	Pt	SE	"	"	160		1000		1000

Section No. 9

Congressional Township No. , N., R. E.

SCALE:—Forty rods to an inch, or ten rods to a space, Congress Land, which is one mile square for a section.
Number of acres in this section according to the UNITED STATES Survey

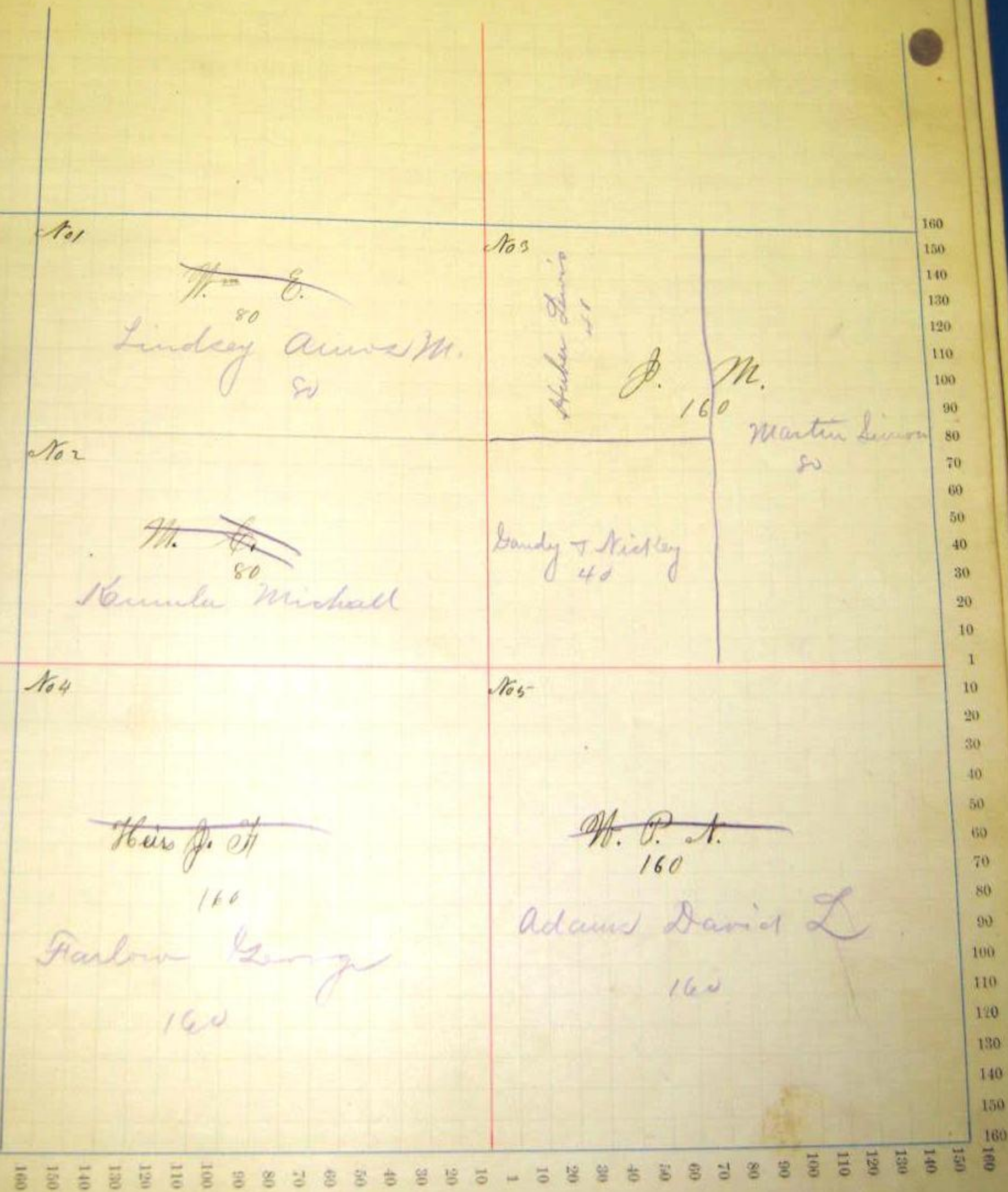

Adams

County, Indiana, 1880.

Assessor's Plat-Book for

Jefferson

Township, No.

NAMES OF OWNERS.	Number on Plat.	DESCRIPTION.	Section.	Township.	Range.	Acres.	Hundredths.	Value of Lands.	Value of Improvements.	Value of Lands and Improvements.
Kofner George	5	E 1/2 NE 1/4	10	25	15	70	60	420	60	480
Hisey John	7	NW 1/2 SE.	10	"	"	80	"	470	100	570
Do	6	SW 1/4	10	"	"	160	"	940	280	1220
Griffin James	8	E 1/2 SE.	10	"	"	68	"	410	120	530
Do	4	NW 1/2 NE.	10	"	"	80	"	470	"	470
Parter Wm	1	1/4	NW	"	"	80	"	480	135	615
Kouser Adam & Jac.	3	SE	NW	"	"	40	"	210	"	210
Clase Corriet H.	2	NE	NW	"	"	40	"	230	15	245

SCALE:—Forty rods to an inch, or ten rods to a space, Congress Land, which is one mile square for a section.
Number of acres in this section according to the UNITED STATES Survey

