

Adams

COUNTY, INDIANA, 1891

Assessor's Plat-Book for

Jefferson

Township, No. 25

NAMES OF OWNERS.	Number on Plat.	DESCRIPTION.			Section.	Township.	Range.	Acres.	Hundredths.	Value of Lands.	Value of Improvements.	Value of Lands and Improvements.
Baker William. C		W 1/4		N E	3	25	15	101	07	1350	200	1550
Do		N 1/2		N W	3	"	"	80		1080	35	1115
Devon W. P.		E 1/2		S E	3	"	"	80		880		880
Delold David. S.		W 1/2	E 1/2	S W	3	"	"	40		500	40	540
Evans Catharine		N 1/2	S 1/2	N W	3	"	"	40		440		440
Gier Martin		E 1/2		N E	3	"	"	79	83	1075	200	1275
Hawk Abel. J.		S 1/2	S 1/2	N W	3	"	"	40		480		480
Hartzog John. F.		W 1/2		S W	3	"	"	80		1040	225	1265
Hartzog Fred. A.		E 1/2	E 1/2	S W	3	"	"	40		500	80	580
Stephenson Wm.		W 1/2		S E	3	"	"	80		880	300	1180



Adams

# COUNTY, INDIANA, 1891

Assessor's Plat-Book for Jefferson

Township, No. 25

NAMES OF OWNERS.	Number on Plat.	DESCRIPTION.	Section.	Township.	Range.	Acres.	Hundredths.	Value of Lands.	Value of Improvements.	Value of Lands and Improvements.
Brandt Louis		SE	4	25	15	40		540	25	
Finkbone Isaac		E 1/2	4	--	--	79	50	900		565
Hochamer Nich--		W 1/2	4	--	--	80		1080	200	900
Hochamer John G.		S 1/2	4	--	--	80		1080	220	1280
Kauk Abel J.		E 1/2	4	"	--	80		1080	275	1355
Johnson James		N 1/2	6	"	"	88		1180		1180
Do		W 1/2	7	"	"	91	12	1225	450	1675
Warner David		N 1/2	4	"	"	80		1080	250	1330
		SW	4	--	"	40		520	20	540

SECTION No. 4

Congressional Township No. 25, R. 15

Scale—Forty rods to an inch, or ten rods to a space, Congress Land, which is one mile square for a section.  
Number of acres in this section, according to the United States Survey,

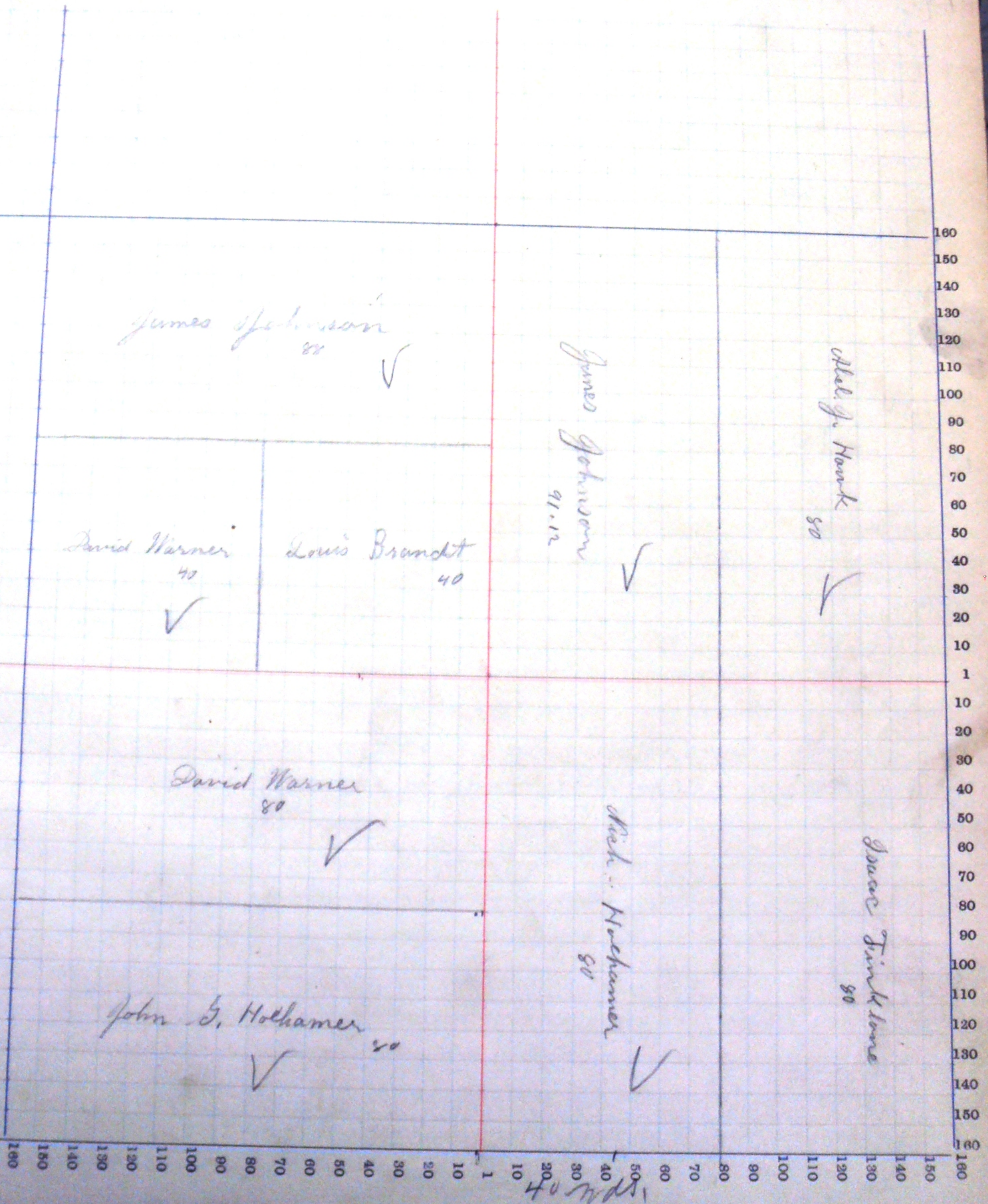

# COUNTY, INDIANA, 1891

Assessor's Plat-Book for

*Jefferson*

Township, No. 25

NAMES OF OWNERS.

Number on Plat.

DESCRIPTION.

Section.

Township.

Range.

Acres.

Hundredths.

Value of Lands.

Value of Improvements.

Value of Lands and Improvements.

NAMES OF OWNERS.	Number on Plat.	DESCRIPTION.	Section.	Township.	Range.	Acres.	Hundredths.	Value of Lands.	Value of Improvements.	Value of Lands and Improvements.
<i>Alexander James. W</i>		<i>NE SE</i>	<i>5</i>	<i>25</i>	<i>15</i>	<i>40</i>		<i>460</i>	<i>100</i>	
<i>Cottrel Francis. M.</i>		<i>E/2 SE SW</i>	<i>5</i>			<i>20</i>		<i>260</i>	<i>150</i>	<i>560</i>
<i>Evans Wiley</i>		<i>SE</i>				<i>80</i>		<i>1080</i>	<i>150</i>	<i>410</i>
<i>Lemant W. J.</i>		<i>E/2 NE</i>				<i>80</i>		<i>1100</i>		<i>1230</i>
<i>McDaniels Minerva J.</i>		<i>NE SW</i>				<i>40</i>		<i>480</i>	<i>200</i>	<i>680</i>
<i>Mater John</i>		<i>W/2 SW</i>				<i>80</i>		<i>1040</i>	<i>125</i>	<i>1165</i>
<i>Permenter Lurisa</i>		<i>E/2 SE SW</i>				<i>37</i>		<i>260</i>	<i>60</i>	<i>320</i>
<i>Studebaker David</i>		<i>W/2 NW</i>				<i>167</i>		<i>2255</i>	<i>400</i>	<i>2655</i>
<i>Do</i>		<i>W/2 NE</i>				<i>80</i>		<i>1080</i>	<i>40</i>	<i>1120</i>
<i>Wells William</i>		<i>NE SE</i>				<i>40</i>		<i>450</i>		<i>450</i>

SECTION NO. 5

Congressional Township No. 25, R. 15

Scale—Forty rods to an inch, or ten rods to a space, Congress Land, which is one mile square for a section.  
Number of acres in this section, according to the United States Survey, \_\_\_\_\_

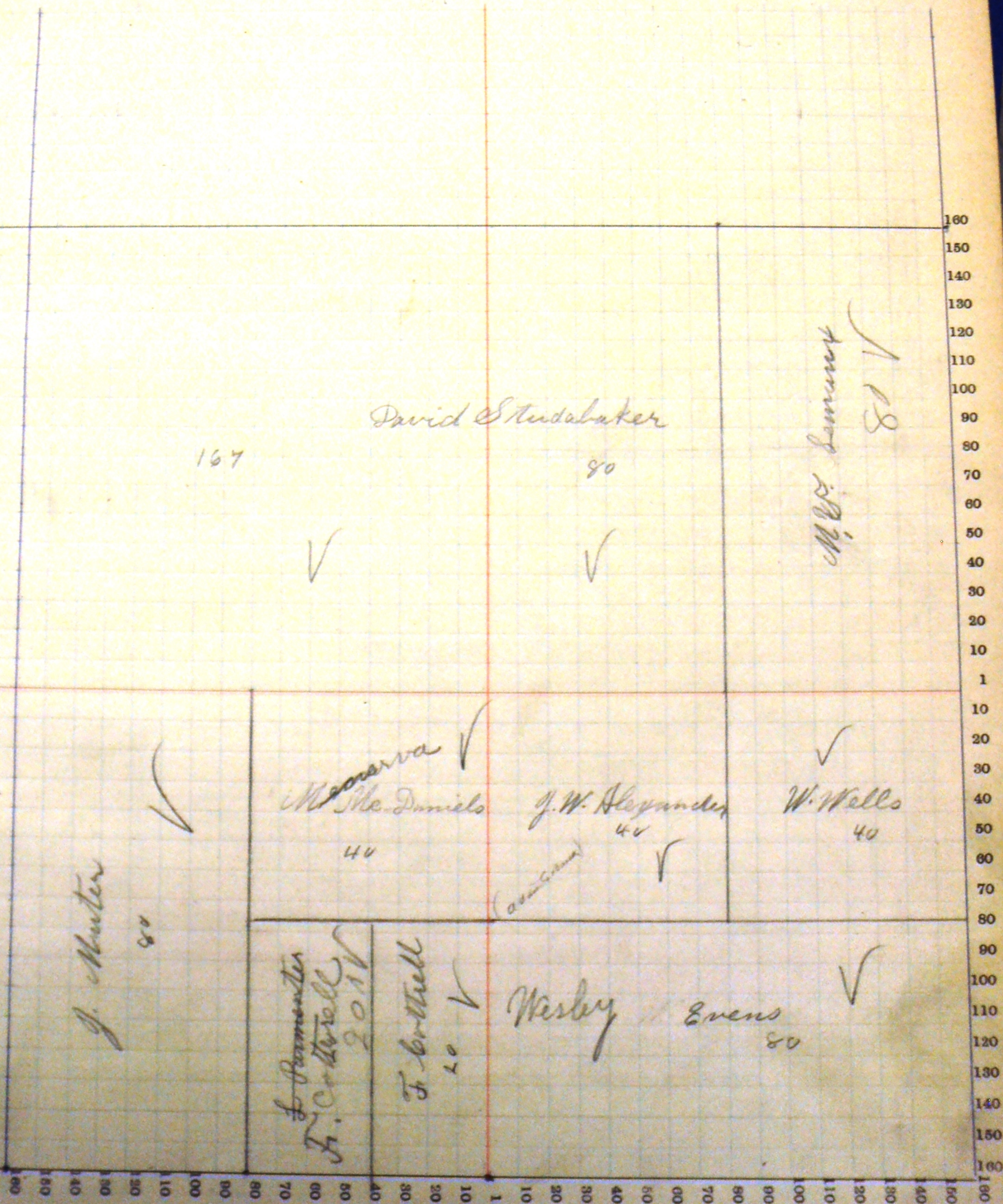

Adams

COUNTY, INDIANA, 1891

Assessor's Plat-Book for

Jefferson

Township, No. 25

NAMES OF OWNERS.	Number on Plat.	DESCRIPTION.	Section.	Township.	Range.	Acres.	Hundredths.	Value of Lands.	Value of Improvements.	Value of Lands and Improvements.
Engle George		E/2 SW	6	25	5	80		1080	150	1230
Eliot Alfred		E/2 NE	6	"	"	40		520	100	620
Hollow John		W/2 SE	6	"	"	80		1040	100	1140
Kuey Andrew J.		SE	6	"	"	40		540	100	640
Kockenberry Nancy		E/2 NE SE	6	"	"	20		250	60	310
Morningstar Henry & Do		W/2 NW	6	"	"	80		1080	100	1180
Meyers Adam		W/2 E/2 NE	6	"	"	40		540	20	560
Miller & Bellman		W/2 NE SE	6	"	"	40		500	150	650
Passon Henry S. Do		NE NW	6	"	"	20		240		240
Teeter Calvin		NW NE	6	"	"	42		565	150	715
Do		SW NE	6	"	"	40		435	15	450
Teeter John F.		NW SW	6	"	"	40		400		400
		SW SW	6	"	"	40		500	125	625
						39 50		530	125	655

SECTION No. 6

Congressional Township No. 25, R. 15

Scale—Forty rods to an inch, or ten rods to a space, Congress Land, which is one mile square for a section.  
Number of acres in this section, according to the United States Survey,

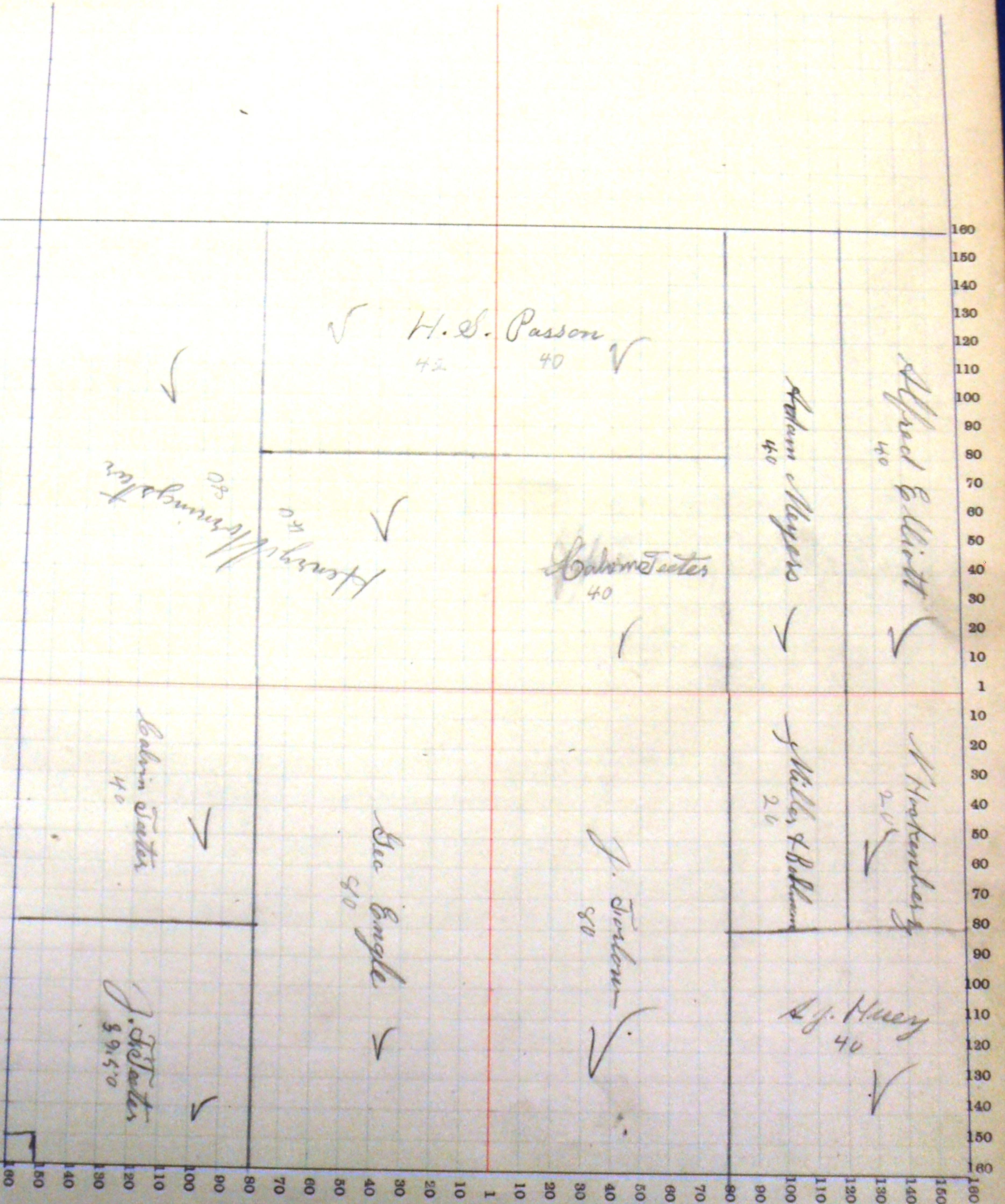



Adams

COUNTY, INDIANA, 1891

Assessor's Plat-Book for

Jefferson

Township, No. 25

NAMES OF OWNERS.	Number on Plat.	DESCRIPTION.	Section.	Township.	Range.	Acres.	Hundredths.	Value of Lands.	Value of Improvements.	Value of Lands and Improvements.
Alnet John		W $\frac{1}{2}$ SE	7	25	15	80		1040	25	1065
Barkalou Pearick		pt NW NW	1	"	"	38		460		460
Boze David		W $\frac{1}{2}$ Sec SW NW	7	"	"	1	25	15	15	30
Cook Sarah, E.		W $\frac{1}{2}$ S $\frac{1}{2}$ SW	7	"	"	53	33	750	20	770
Ementizer James, W.		pt NW	4	"	"	2		25		25
Do		Ept Spt NE	7	"	"	20		200	25	225
Do		Wpt NE	7	"	"			10667	1060	1060
			"	"	"					
			"	"	"					
Kizer Emanuel		NE NW	7	"	"	40		400	20	420
Leiming Jasper		S $\frac{1}{2}$ NW	7	"	"	98		925	50	975
Macy Thomas, E.		W $\frac{1}{2}$ SW	7	"	"	80		1080	300	1380
Meyers Reuben		Spt Ept NE	7	"	"	33	33	335		335
Priest S Curtis		E $\frac{1}{2}$ SE	7	"	"	80		880		880
Rymple John		E $\frac{1}{3}$ S $\frac{1}{2}$ SW	7	"	"	28	88	350	40	390

SECTION NO. 7

Congressional Township No. 25, R. 15

Scale—Forty rods to an inch, or ten rods to a space, Congress Land, which is one mile square for a section.  
Number of acres in this section, according to the United States Survey.



Adams

# COUNTY, INDIANA, 1891

Assessor's Plat-Book for

Jefferson

Township, No. 25

NAMES OF OWNERS.	Number on Plat.	DESCRIPTION.	Section.	Township.	Range.	Acres.	Hundredths.	Value of Lands.	Value of Improve-ments.	Value of Lands and Improve-ments.
Anderson, J. H. Jr		W <sup>1/2</sup> SE	8	25	15	80		1080		1080
Emenhiser James W.		SE NW	8			40		400		400
Fogle Jacob		pt SW NE	8		"	32		385	80	465
Kuey Andrew J		SE NW	8		"	40		800		800
Harden John		NE NE	8		"	40		520	80	600
Jack Robert W.		NE NW	8		"	40		440	75	515
Knepper Jacob H.		N pt SW	8			102		1375	100	1475
Do		S pt SW	8			58		775	100	875
Lutter John P.		N pt W <sup>1/2</sup> NE	8			48		645	80	725
Priest S Curtis		SE NE	8		"	40		440		440
Pa		E <sup>1/2</sup> SE	8		"	80		880		880

Scale—Forty rods to an inch, or ten rods to a space, Congress Land, which is one mile square for a section.  
Number of acres in this section, according to the United States Survey,

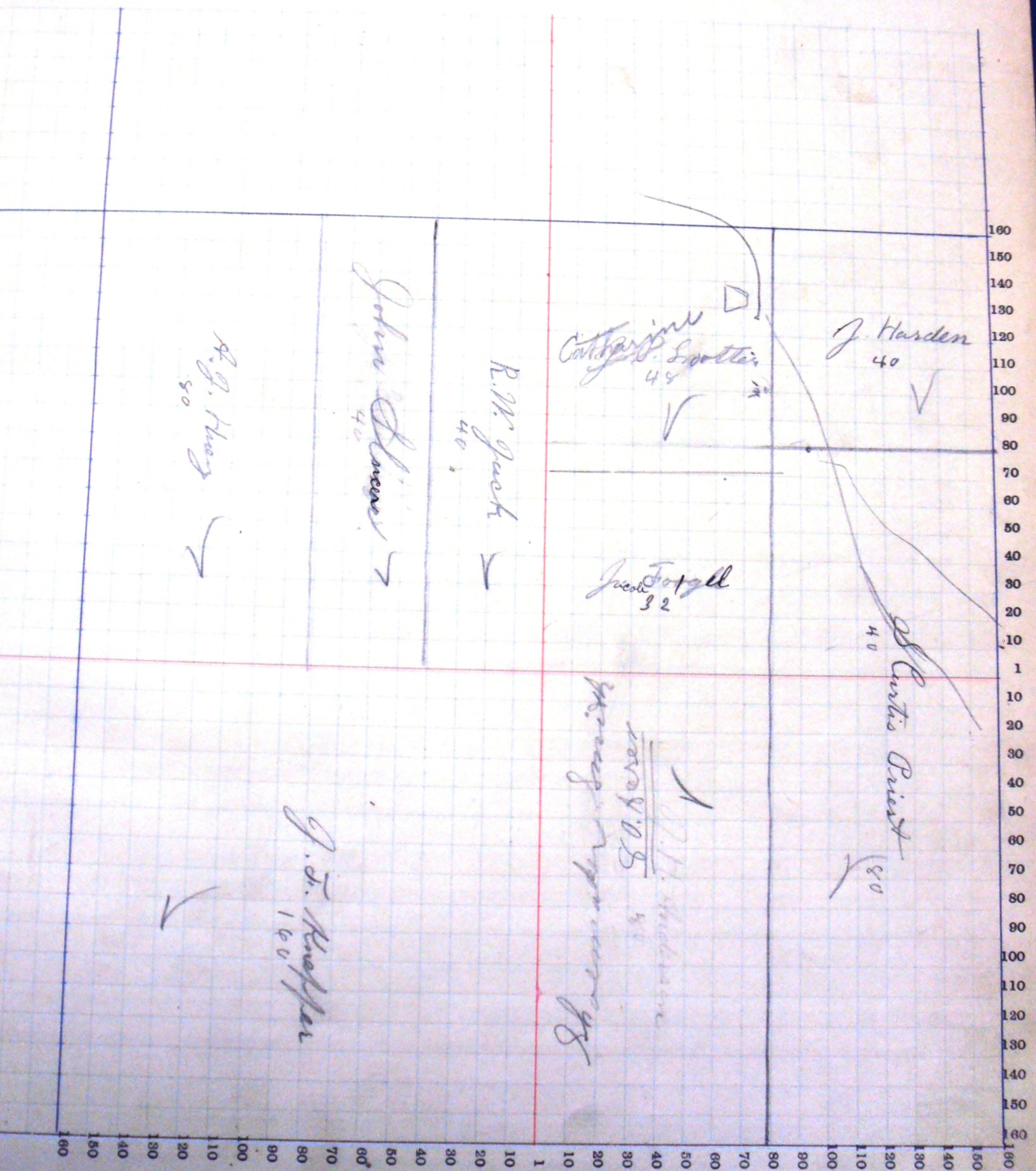

Adams

COUNTY, INDIANA, 1891

Assessor's Plat-Book for

Jefferson

Township, No. 25

NAMES OF OWNERS.	Number on Plat.	DESCRIPTION.	Section.	Township.	Range.	Acres.	Hundredths.	Value of Lands.	Value of Improvements.	Value of Lands and Improvements.
								<del>1080</del>	<del>250</del>	<del>1330</del>
Adams David L.		W. 2	SE	9	25	15	80	1080	250	1330
Butler Frederick		S 1/2	NW NE	9	"	"	20	260	75	335
Engle Josiah		NE	NW NE	9	"	"	10	135	125	260
Farlow George			SW	9	"	"	100	2160	275	2435
Gilmore Alexander		NE	NE	9	"	"	40	540	100	640
Huber Lewis		pt	NW NE	9	"	"	10	135	150	285
Hill William G.		SW	NE	9	"	"	40	540	75	615
Kumler Michael		S 1/2	NW	9	"	"	80	950		950
Lindsey Amos M.		N 1/2	NW	9	"	"	80	1080	220	1300
Martin Simon		SE	NE	9	"	"	40	440		440
Nash George E.		SE	SE	9	"	"	40	400	50	450
Nash John C. Jr.		NE	SE	9	"	"	40	400	90	490

# SECTION NO. 4

Congressional Township No. 25, R. 15

Scale—Forty rods to an inch, or ten rods to a space, Congress Land, which is one mile square for a section.  
 Number of acres in this section, according to the United States Survey.

