

Assessor's Plat-Book for

*Kirkland*

Township, No. *29*

NAMES OF OWNERS.	Number of Tracts.	DESCRIPTION.	Section.	Township-Range.	Acres.	Hundredths.	Value of Land.	Value of Improvements.	Total Value.
<i>Samuel G. Jones</i>		<i>NE NE</i>	<i>25</i>	<i>27 13</i>	<i>10</i>		<i>1050</i>	<i>900</i>	<i>2500</i>
<i>do</i>		<i>Npt NE</i>	<i>25</i>	<i>27 13</i>	<i>105</i>		<i>2500</i>		<i>2500</i>
<i>Mary E. Hunter</i>		<i>Npt NW NE</i>	<i>25</i>	<i>27 13</i>	<i>15</i>		<i>400</i>	<i>125</i>	<i>2500</i>
<i>Charles B. Niblack</i>		<i>NE NW</i>	<i>25</i>	<i>27 13</i>	<i>10</i>		<i>1050</i>	<i>350</i>	<i>5750</i>
<i>George P. Shaft</i>		<i>NW NW</i>	<i>25</i>	<i>27 13</i>	<i>40</i>		<i>1040</i>	<i>225</i>	<i>1400</i>
<i>Wm. Esber</i>		<i>NW 1/2 SW</i>	<i>25</i>	<i>27 13</i>	<i>80</i>		<i>2150</i>	<i>400</i>	<i>1250</i>
<i>Reta S. Staffen</i>		<i>SW 1/2 SW NW</i>	<i>25</i>	<i>27 13</i>	<i>20</i>		<i>520</i>		<i>2500</i>
<i>do</i>		<i>Npt SW NW</i>	<i>25</i>	<i>27 13</i>	<i>60</i>		<i>1600</i>	<i>100</i>	<i>2220</i>
<i>Antonia &amp; Sophia Mayer</i>		<i>Npt SE</i>	<i>25</i>	<i>27 13</i>		<i>25</i>	<i>10</i>	<i>275</i>	<i>2500</i>
<i>S. E. Mills</i>		<i>E 1/2 SE</i>	<i>25</i>	<i>27 13</i>	<i>80</i>		<i>2150</i>	<i>600</i>	<i>2750</i>
<i>Samuel H. Hoaker</i>		<i>E 1/2 SW</i>	<i>25</i>	<i>27 13</i>	<i>80</i>		<i>2150</i>		<i>2750</i>
<i>do</i>		<i>NW 1/2 SE</i>	<i>25</i>	<i>27 13</i>	<i>80</i>		<i>2150</i>	<i>800</i>	<i>5000</i>

SECTION No. 25

Congressional Township No. 27, R. 12

SCALE—Forty rods to an inch, or ten rods to a space, Congress Land, which is one mile square for a section.  
Number of acres in this section, according to the United States Survey, \_\_\_\_\_

Value of Improvements	Value of Land and Improvements
2850	
2500	
575	
1400	
1265	
2550	
2220	
285	
2750	
6100	

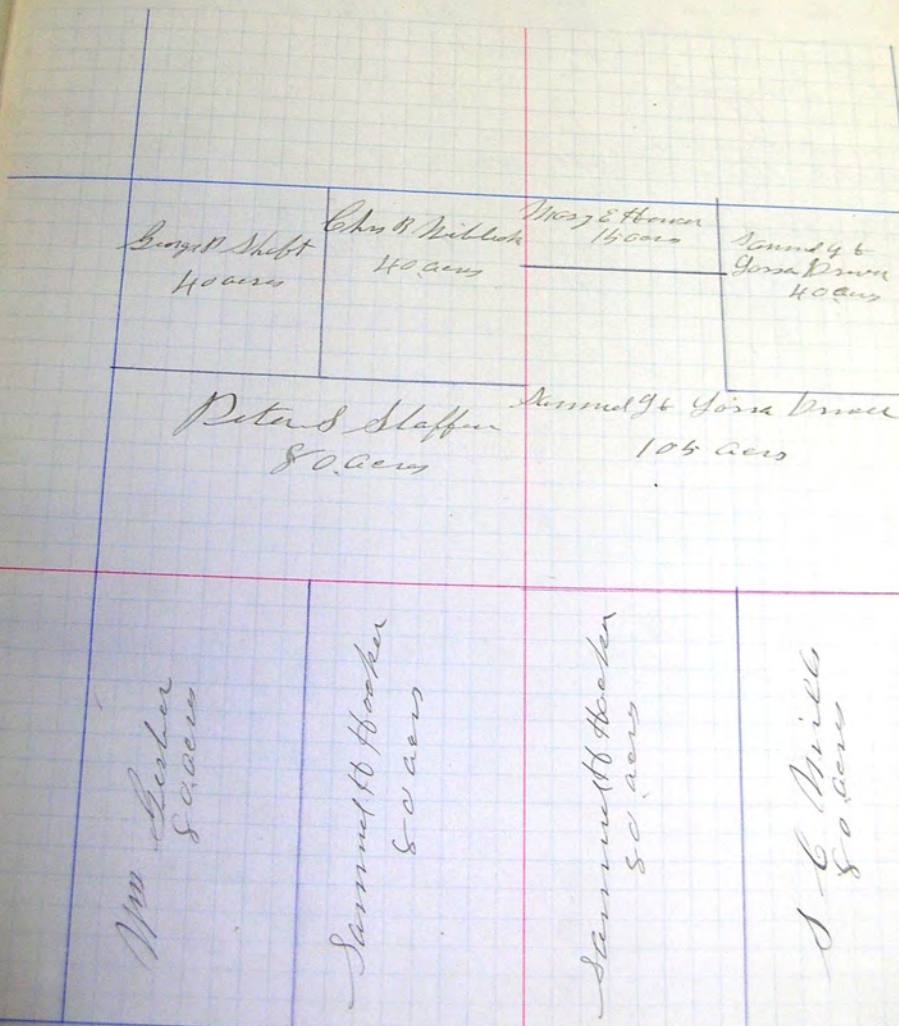

160  
150  
140  
130  
120  
110  
100  
90  
80  
70  
60  
50  
40  
30  
20  
10  
1  
10  
20  
30  
40  
50  
60  
70  
80  
90  
100  
110  
120  
130  
140  
150  
160

160  
150  
140  
130  
120  
110  
100  
90  
80  
70  
60  
50  
40  
30  
20  
10  
1  
10  
20  
30  
40  
50  
60  
70  
80  
90  
100  
110  
120  
130  
140  
150  
160

Assessor's Plat-Book for

*Kirkland*

Township, No. *27*

NAMES OF OWNERS.	Number on Plat.	DESCRIPTION.	Section.	Township.	Range.	Acres.	Hundredths.	Value of Land.	Value of Improvements.	Value of Personal Property.
<i>Eliyah Pease</i>		<i>NW</i>	<i>33</i>	<i>27</i>	<i>13</i>	<i>160</i>		<i>1440</i>	<i>800</i>	
<i>John Souice</i>		<i>pt E 1/2 SW</i>	<i>33</i>	<i>27</i>	<i>13</i>	<i>30</i>		<i>875</i>	<i>60</i>	<i>5200</i>
<i>do "</i>		<i>SW</i>	<i>33</i>	<i>27</i>	<i>13</i>	<i>40</i>		<i>1100</i>		
<i>Emanuel Saska</i>		<i>pt SW</i>	<i>33</i>	<i>27</i>	<i>13</i>	<i>70</i>		<i>1840</i>	<i>750</i>	<i>1975</i>
<i>do "</i>		<i>pt NW 1/2 SW</i>	<i>33</i>	<i>27</i>	<i>13</i>	<i>10</i>		<i>260</i>		
<i>John Dieback</i>		<i>pt NW 1/2 SW</i>	<i>33</i>	<i>27</i>	<i>13</i>	<i>25</i>		<i>675</i>	<i>600</i>	<i>2750</i>
<i>Harrison Thomas</i>		<i>SE</i>	<i>33</i>	<i>27</i>	<i>13</i>	<i>140</i>		<i>1050</i>	<i>200</i>	<i>1250</i>
<i>Samuel Saska</i>		<i>pt NW 1/2 SW</i>	<i>33</i>	<i>27</i>	<i>13</i>	<i>5</i>		<i>125</i>		<i>1250</i>
<i>Joseph Pease</i>		<i>pt NW 1/2 NE</i>	<i>33</i>	<i>27</i>	<i>13</i>	<i>60</i>		<i>1660</i>	<i>200</i>	<i>1250</i>
<i>do "</i>		<i>NW 1/2 NW 1/2 NE</i>	<i>33</i>	<i>27</i>	<i>13</i>	<i>20</i>		<i>550</i>		
<i>Jefferson &amp; David Grinn</i>		<i>E 1/2 NE</i>	<i>33</i>	<i>27</i>	<i>13</i>	<i>85</i>		<i>2160</i>	<i>650</i>	<i>2810</i>
<i>Jack Kaehe</i>		<i>N 1/2 SE</i>	<i>33</i>	<i>27</i>	<i>13</i>	<i>50</i>		<i>2220</i>	<i>350</i>	<i>2570</i>
<i>Reta Steffens</i>		<i>pt NW 1/2 SW</i>	<i>33</i>	<i>27</i>	<i>13</i>	<i>20</i>		<i>540</i>		<i>540</i>

*Land per acre 27.45*

SECTION No. 83

SCALE—Forty rods to an inch, or ten rods to a space, Congress Land, which is one mile square for a section. Number of acres in this section, according to the United States Survey, 639

Value of Land	Value of Improvements	Value of Land and Improvements
1400	800	
875	60	5200
100		
100	750	1555
		2950
600		1270
200		1280
		125
200		
	2610	
650	2810	
350	2570	
	540	



160  
150  
140  
130  
120  
110  
100  
90  
80  
70  
60  
50  
40  
30  
20  
10  
1  
160  
150  
140  
130  
120  
110  
100  
90  
80  
70  
60  
50  
40  
30  
20  
10  
1

COUNTY, INDIANA, 1907.

Assessor's Plat-Book for

*Kirkland*

Township, No. *27*

NAMES OF OWNERS.	Number of Plat.	DESCRIPTION.	Section.	Township.	Range.	Acres.	Hundredths.	Value of Land.	Value of Improvements.	Value of Personal Property.
<i>Arion Moore</i>		<i>SE</i>	<i>34</i>	<i>27</i>	<i>13</i>	<i>156.50</i>	<i>1200</i>	<i>400</i>		
<i>Indiana Barber</i>		<i>SW Cor SE</i>	<i>34</i>	<i>27</i>	<i>13</i>	<i>3.50</i>	<i>100</i>	<i>25</i>		<i>5000</i>
<i>Wm J. Hancock</i>		<i>NE 1/4 NE</i>	<i>34</i>	<i>27</i>	<i>13</i>	<i>29.66</i>	<i>810</i>			<i>1200</i>
<i>Mary D Hancock</i>		<i>SW 1/4 NE</i>	<i>34</i>	<i>27</i>	<i>13</i>	<i>29.66</i>	<i>810</i>	<i>525</i>		<i>500</i>
<i>Catherine Gibby</i>		<i>SW</i>	<i>34</i>	<i>27</i>	<i>13</i>	<i>120</i>		<i>3300</i>	<i>630</i>	<i>1330</i>
<i>Joseph &amp; Elizabeth Reinhard</i>		<i>NE 1/4 SW</i>	<i>34</i>	<i>27</i>	<i>13</i>	<i>110</i>		<i>1110</i>	<i>550</i>	<i>3550</i>
<i>do</i>		<i>SW 1/4 SW</i>	<i>34</i>	<i>27</i>	<i>13</i>	<i>40</i>		<i>1110</i>		
<i>do</i>		<i>NE 1/4 SW</i>	<i>34</i>	<i>27</i>	<i>13</i>	<i>40</i>		<i>1110</i>		
<i>Mary E Reary</i>		<i>NE 1/4 SW</i>	<i>34</i>	<i>27</i>	<i>13</i>	<i>40</i>		<i>1080</i>	<i>350</i>	<i>3000</i>
<i>John E. Reary</i>		<i>SW</i>	<i>34</i>	<i>27</i>	<i>13</i>	<i>59.70</i>	<i>1630</i>	<i>500</i>		<i>1430</i>
<i>John H. Reary</i>		<i>SW 1/4 SW</i>	<i>34</i>	<i>27</i>	<i>13</i>	<i>110</i>		<i>1100</i>		<i>2130</i>
<i>David Crum</i>		<i>SW 1/4 NE</i>	<i>34</i>	<i>27</i>	<i>13</i>	<i>22</i>		<i>600</i>	<i>50</i>	<i>1100</i>
<i>do</i>		<i>SW 1/4 NE</i>	<i>34</i>	<i>27</i>	<i>13</i>	<i>18</i>		<i>1480</i>		<i>1140</i>

*Land per acre 27.21*  
*and 53.50*

1907.

No. 27

SECTION No. 311

Congressional Township No. 27, R. 13

SCALE—Forty rods to an inch, or ten rods to a space, Congress Land, which is one mile square for a section. Number of acres in this section, according to the United States Survey, 639.

5000  
125  
410  
1335  
3750  
3840  
1430  
130  
150  
40

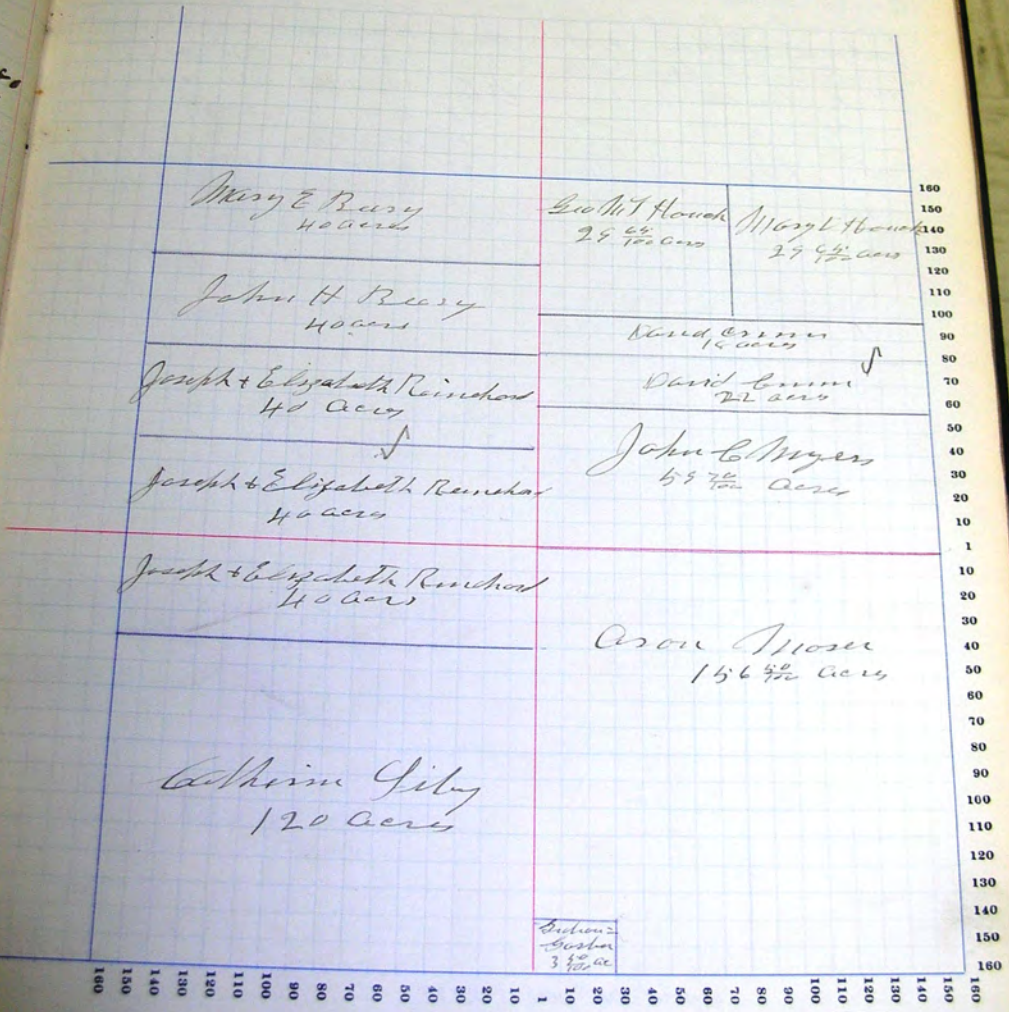

160  
150  
140  
130  
120  
110  
100  
90  
80  
70  
60  
50  
40  
30  
20  
10  
1  
1  
20  
30  
40  
50  
60  
70  
80  
90  
100  
110  
120  
130  
140  
150  
160

NAMES OF OWNERS.	Number of Plats.	DESCRIPTION.	Section.	Township.	Range.	Acres.	Mfrs. & Inds.	Value of Land.	Value of Improvements.	Value of Total Platted Land.
<i>Henry Hiltge</i>		<i>N 1/2</i>	<i>S 16</i>	<i>35</i>	<i>27</i>	<i>13</i>	<i>50</i>	<i>2200</i>	<i>200</i>	<i>2400</i>
<i>Jud W. Hurlner</i>		<i>S 1/2</i>	<i>S 16</i>	<i>35</i>	<i>27</i>	<i>13</i>	<i>50</i>	<i>2150</i>	<i>700</i>	<i>2850</i>
<i>Henry Brown</i>		<i>N 1/2</i>	<i>S 16</i>	<i>35</i>	<i>27</i>	<i>13</i>	<i>79 31</i>	<i>2170</i>	<i>300</i>	<i>2470</i>
<i>Lyman L. Salter, R. Smith</i>		<i>pt N 1/2</i>	<i>cor N 1/2</i>	<i>35</i>	<i>27</i>	<i>13</i>	<i>42</i>	<i>15</i>	<i>150</i>	<i>240</i>
<i>John C. Brown</i>		<i>S 1/2</i>	<i>N E</i>	<i>35</i>	<i>27</i>	<i>13</i>	<i>80</i>	<i>1650</i>	<i>1500</i>	<i>3150</i>
<i>Rachel Sigouletsky</i>		<i>S 1/2</i>	<i>NW</i>	<i>35</i>	<i>27</i>	<i>13</i>	<i>80</i>	<i>2200</i>	<i>1450</i>	<i>3650</i>
<i>Jm F. Feltz</i>			<i>N E</i>	<i>35</i>	<i>27</i>	<i>13</i>	<i>160</i>	<i>4300</i>	<i>1000</i>	
<i>do "</i>		<i>NW</i>	<i>S E</i>	<i>35</i>	<i>27</i>	<i>13</i>	<i>40</i>	<i>1100</i>		
<i>do "</i>		<i>N E</i>	<i>S E</i>	<i>35</i>	<i>27</i>	<i>13</i>	<i>40</i>	<i>1050</i>		
<i>Mrs Adler</i>		<i>S 1/2</i>	<i>S E</i>	<i>35</i>	<i>27</i>	<i>13</i>	<i>40</i>	<i>1080</i>	<i>450</i>	<i>1530</i>
<i>do "</i>		<i>S E</i>	<i>S E</i>	<i>35</i>	<i>27</i>	<i>13</i>	<i>40</i>	<i>1050</i>		<i>1050</i>

*Land per acre 2719*

SECTION No. 36.

Congressional Township No. 27, R. 13

SCALE—Forty rods to an inch, or ten rods to a space, Congress Land, which is one mile square for a section.  
Number of acres in this section, according to the United States Survey, 629

Value of Improved lands	Value of Unimproved lands
200	2400
700	2650
300	2470
150	205
100	2120
50	2650
0	0

7850  
1530  
1050

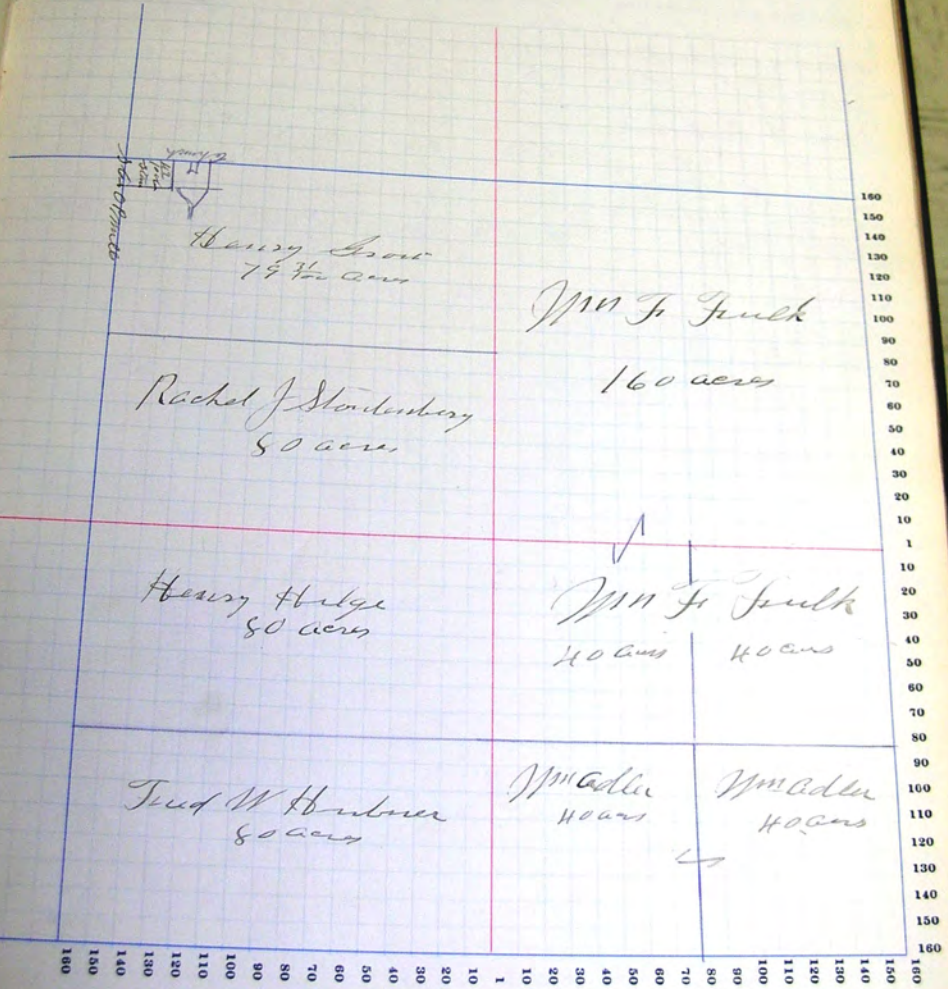



Adams COUNTY, INDIANA, 1907.

Assessor's Plat-Book for Kushland

Township, No. 22

Pub. by the State Printer, Indianapolis

NAMES OF OWNERS.	Number of Plat.	DESCRIPTION.	Section.	Township.	Range.	Acres.	Hundredths.	Value of Land.	Value of Improvements.	Value of Land and Improvements.
Abraham Fingate		N 1/2 SE	36	27	13	80		2100	540	
David F Fingate		SE	36	27	13	160		1060		2650
Eliza M Johnson		W 1/2 NW NW	36	27	13	30		800	250	1050
Gene Neuenchwander		N 1/2 SE	36	27	13	80		2100	350	2450
Edmund & Electra J Bucher		W 1/2 NE NE	36	27	13	20		450		450
Leah Ann C. Butcher		E 1/2 NE NE	36	27	13	20		500	150	650
Wm J Brewer		N 1/2 NW	36	27	13	145		1225	275	1500
Jesse J Babcock		S 1/2 NW	36	27	13	140		1100	500	
do		N 1/2 SW	36	27	13	80		2200		3800
Marcilleus C. Norris		S 1/2 SW	36	27	13	80		2170	600	2770
Hattie Studabaker		W 1/2 NE	36	27	13	80		2225	800	
do		E 1/2 E 1/2 NW	36	27	13	145		1250		4475

SECTION No. 26

Congressional Township No. 22, R. 13

SCALE—Forty rods to an inch, or ten rods to a space, Congress Land, which is one mile square for a section.  
Number of acres in this section, according to the United States Survey, 640

Value of Land and Improvement

2650  
1060  
1050  
2490  
1450  
650  
1500  
3800  
2770  
475

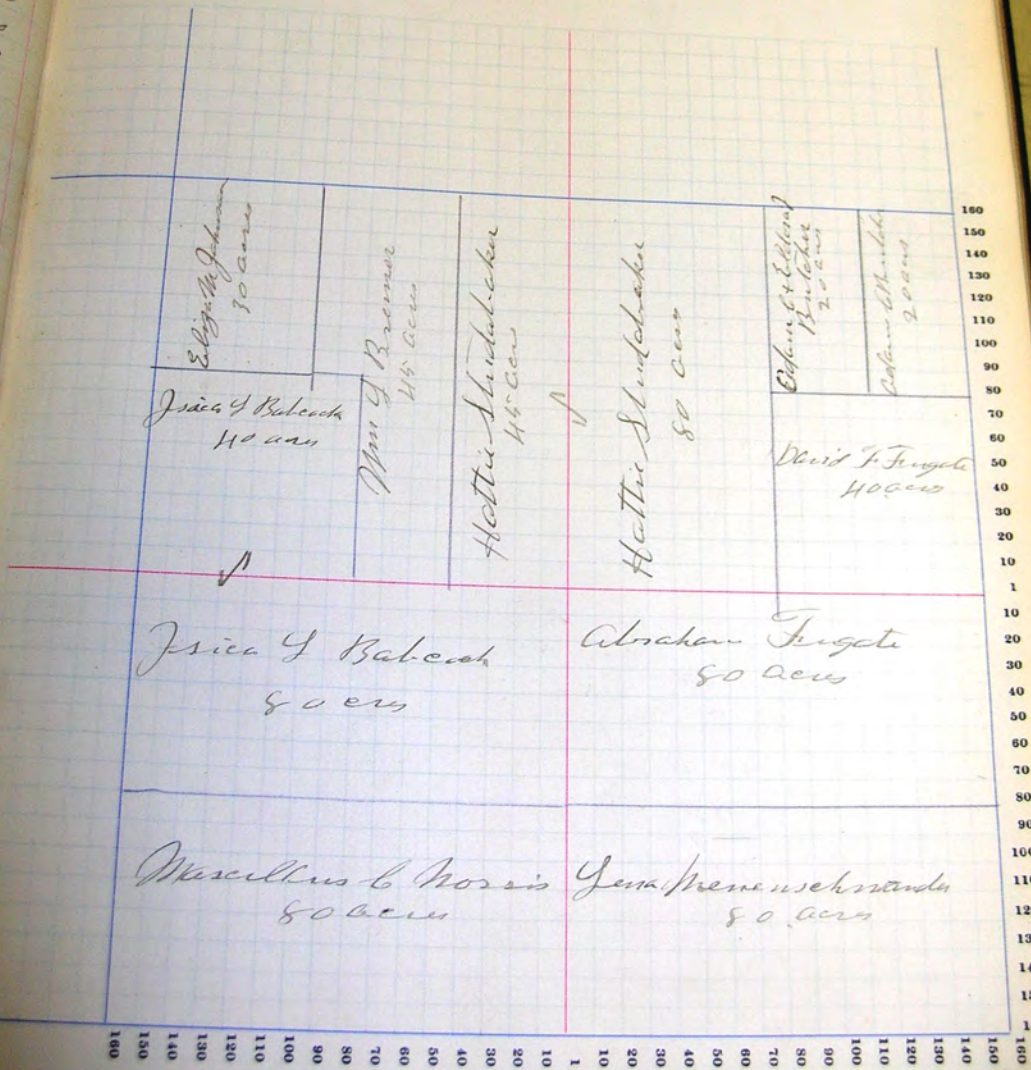

160  
150  
140  
130  
120  
110  
100  
90  
80  
70  
60  
50  
40  
30  
20  
10  
1  
10  
20  
30  
40  
50  
60  
70  
80  
90  
100  
110  
120  
130  
140  
150  
160