

## JACKSON TOWNSHIP

According to A STANDARD HISTORY OF JASPER AND NEWTON COUNTIES, INDIANA, published by the Lewis Publishing Co., Chicago and New York, 1916, the town of Mount Ayr, first called Mount Airy, was laid out by Lewis Marion on October 18, 1882.

When the town was very young, an article appeared in the GOODLAND HERALD, which reported that "The village has the advantage of a good school---".

From Mr. and Mrs. George Holley I learned that the Mount Ayr School which preceded the present building was a two story wooden structure. They and Mrs. Dale Weston helped in locating the sites of the early one room schools as follows:

School No. 1, Section 3, North Star  
School No. 2, Section 19  
School No. 3, Section 11  
School No. 4, at Mount Ayr, Section 23  
School No. 5, Section 15  
School No. 6, Section 30  
School No. 7, Section 27  
School No. 8, Section 35

The present school building at Mount Ayr was erected in 1917-18, during Superintendent W.O. Schanlaub's long career as County Superintendent. He put forth tremendous effort to consolidate the Newton County Schools. An addition for shop and music was erected in 1954.

Until 1968, when the North Newton High School was ready, the Mount Ayr building housed both Elementary and High School, after which it was used for grades one through six. During the school year 1975-76 the seventh graders of the entire North Newton School Corporation attended there. In the school year 1976-77 it became the Junior High for the corporation.

As I was unable to obtain a complete list of all the teachers who have taught in the township, it did not seem fair to submit a partial list.

Mr. Percy Chamberlain, who attended the No. 7, one room school said that most of the teachers were eighth grade graduates with a six weeks training course. He said they drove to school by horse and buggy, built their own fires, and were responsible for keeping the building clean. He related that

one of his teachers would get the mail, put his feet on his desk, begin to read the news, and go to sleep. The pupils would slip out and go home.

My late husband, Irvin Carter, told me that when he was in the upper grades of North Star, his teacher was his cousin, Gay Makeever. The older boys would roam the woods during the lunch hour. A little Amish boy persisted in following them around. One day they caught him, removed his trousers, threw them up in a tree, and went back to school. The teacher immediately sent the culprits home.

Nellie Carter

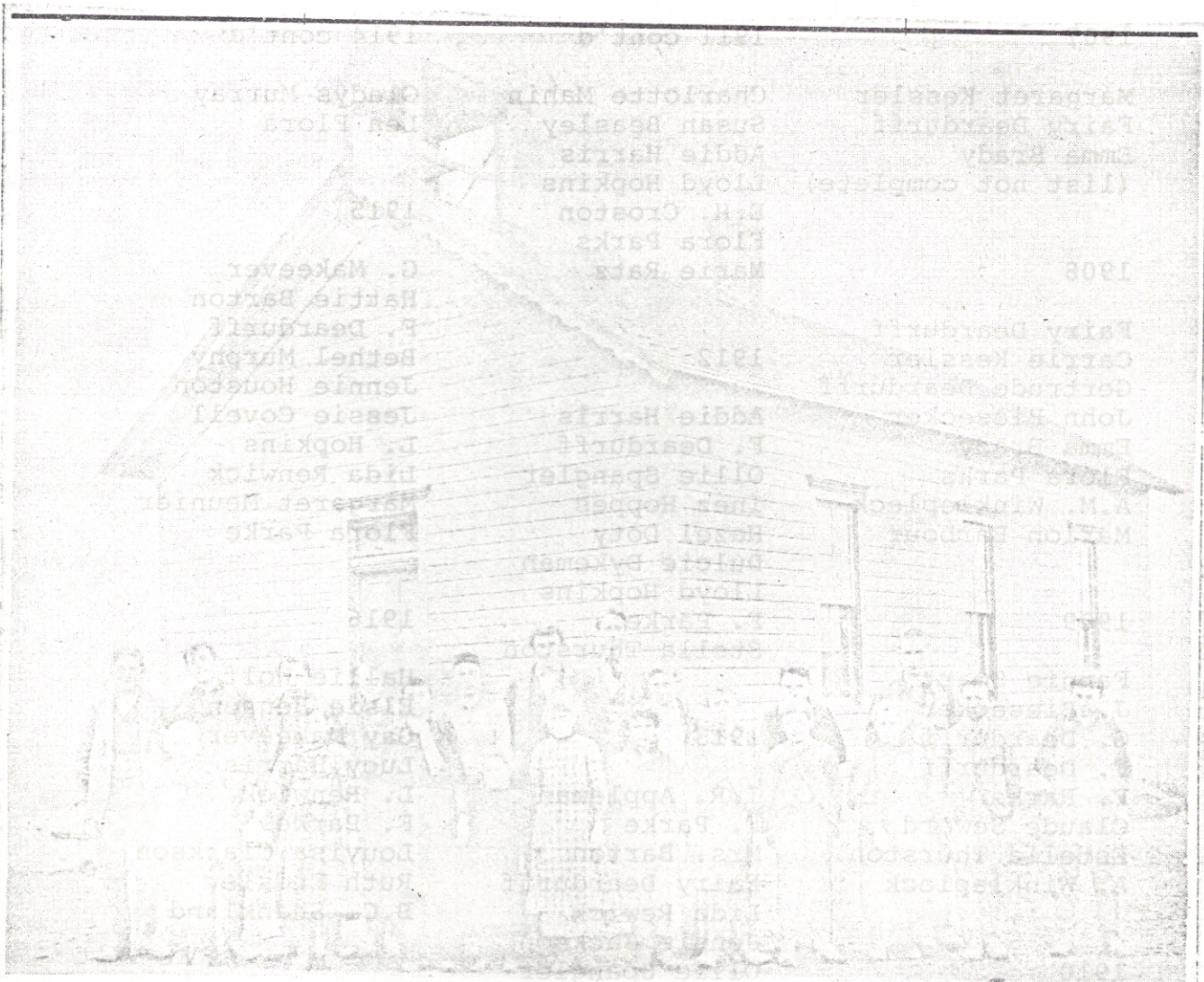

HAPPY DAYS AT OLD KENNEDY NO. 6—Pictured here are some of the pupils enrolled in the Kennedy No. 6 School a few (?) years ago. Back Row—Carl Peterson, Claud Holley, Jimmie Coberly, Kinder Kennedy, Ruby Kennedy, Charlie Holley, Jesse Marrion (teacher), Fred Coberly, Oscar Holley and Emmet Kennedy. Front Row—Charlie Doctor, Della Mayhew, Nellie Doctor, Nellie Kennedy, Anna Doctor, Guy Holley, Otto Mayhew, George Coberly, Jennie Brunton, Earl Kennedy and Elmer Brunton. Some of the pupils were absent when the photograph was taken. The complete enrollment as told to the Courier included the following: Kennedy—Grace, Ruby, Emmet, Kinder, Earl, Sam, Nellie, Bertha and Frieda; Doctor—Nellie, Anna, Charlie, Arthur, and Lawrence; Holley—Charlie, Claud, Oscar, and Guy; Mayhew—Cecil, Otto and Della; Brunton—Ralph, Everett, Delmer, Ada, Lora, Elmer, Jennie, Willie and Harry; Carpenter—Velma, Opal and Van; Agate—Ona and Vera; Coberly—Jimmie, Fred, George and Iva; Carl Peterson; Alvin Baldwin and Ada Ewan. Kennedy No. 6 was located a few miles east of Morocco.

## JACKSON TOWNSHIP'S TEACHERS

1907	1911 cont'd	1914 cont'd
Margaret Kessler Fairy Deardurff Emma Brady (list not complete)	Charlotte Mahin Susan Beasley Addie Harris Lloyd Hopkins E.H. Croston Flora Parks Marie Ratz	Gladys Murray Lea Flora
1908		1915
Fairy Deardurff Carrie Kessler Gertrude Deardurff John Biesecker Emma Brady Flora Parks A.M. Winklepleck Marion Barbour	1912  Addie Harris F. Deardurff Ollie Spangler Inez Hoppes Hazel Doty Dulcie Dykeman Lloyd Hopkins F. Parke Stella Thurston	G. Makeever Hattie Barton F. Deardurff Bethel Murphy Jennie Houston Jessie Covell L. Hopkins Lida Renwick Margaret Meunier Flora Parke
1909		1916
Fannie Smart J. Biesecker G. Deardurff F. Deardurff F. Parks Claude Seward Estella Thurston A. Winklepleck	1913  I.R. Appleman F. Parke Mrs. Barton Fairy Deardurff Lida Rewick Jennie Jackson Ollie Spangler Jessie Covell L. Hopkins Gertrude Murphy	Hallie Wolf Elsie Benson Gay Makeever Lucy Harris L. Renwick F. Parke Louvisa Clarkson Ruth Endsley B.C. Shankland
1910		1917
F. Deardurff Cloyd Harkins Claude Seward Addie Harris Maude Beasley Charlotte Mahin J. Illingsworth F. Park	1914  Gay Makeever F. Deardurff Linda Rewick Vera Agate L. Hopkins J. Covell F. Park Mary Darnell	Florence Coffyn Susie Wood Bethel Murphy F. Parke Lucy Harris Elsie Benson Lida Renwick J.B. Harter Orpha Collier
1911		1918
Ollie Spangler F. Deardurff		Lucy Harris

1918 cont'd

Susie Wood  
 Elsie Benson  
 L. Renwick  
 Viola Bovty  
 F. Coffyn  
 Lucile Waltz  
 F. Parke  
 Mabel Ellis

1919

Lucy Harris  
 S. Wood  
 G. Makeever  
 L. Renwick  
 J.C. Tranbarger  
 Mildred Shiltz  
 Madge Humrichhouse  
 Gladys Weber

1920

Dorothro Burnard  
 J. Tranbarger  
 L. Harris  
 S. Wood  
 G. Makeever  
 L. Renwick  
 Blanch Bridewell  
 B. Murphy  
 Eulala Hormell

1921

J. Tranbarger  
 Mrs. J. Tranbarger  
 Mattie Geesa  
 G. Makeever  
 Mary Gilmore  
 Alice Hazel  
 L. Renwick  
 Clesta Walker  
 S. Wood  
 Blanch Bridewell

1922

A. Hazel  
 B. Bridwell  
 M. Gilmore  
 Eva Johnson  
 J. Tranbarger  
 M. Tranbarger  
 Orlin Cooley  
 M. Geesa

1923

Eva Robinson  
 Ethel Peters  
 Earl Applegate  
 Hubert Long  
 Clifford Davis  
 Ruby Hillyer  
 Vernon Sigler  
 A. Hazel

1924

E. Applegate  
 Lorah Church  
 Gertrude Black  
 Ralph Byers  
 Hilda Sparks  
 E. Peters

1925

E. Applegate  
 G. Black  
 L. Church  
 Agnes Kiper  
 A. Pershing  
 M. Hazel  
 Bernice Anderson  
 E. Peters

1926

G. Webber  
 Dorothea Wolfe  
 L. Church  
 Ursel McCoy

1926 cont'd

Otto Coyle  
 M. Hazel  
 Mabel Johnson  
 E. Peters

1927

Gladys Webber  
 D. Wolfe  
 Ernest Horn  
 William Nusbaum  
 Louise Witters  
 A. Hazel  
 M. Johnson  
 E. Peters

1928

G. Webber  
 D. Wolfe  
 E. Horn  
 Estes Hendricks  
 L. Witters  
 Mildred Crabb  
 M. Johnson  
 Marvell Byfield

1929

G. Webber  
 D. Wolfe  
 E. Horn  
 Kenneth Shafer  
 Beatrice Collings  
 G. Makeever  
 M. Johnson  
 M. Byfield

1930

G. Webber  
 D. Wolfe  
 Byron Laird  
 K. Shafer  
 Lena Stults  
 G. Makeever

1930 cont'd

Margaret Day  
Wilma Mansfield

1931 & 1932

Gladys Webber  
D. Wolfe  
K. Shafer  
Byron Laird  
Ethel Martin  
G. Makeever  
Margaret Shook  
Isabelle Blickenstaff

1933

G. Webber  
D. Wolfe  
K. Shafer  
B. Laird  
G. Makeever  
M. Schiltz  
Alice Kemper  
Ivan Eberly

1932

A. Hazel  
B. Bridwell  
M. Gilmore  
Eva Johnson  
J. Trapnager  
M. Trapnager  
Orlin Cooley  
M. Geesa

1933

Eva Robinson  
Ethel Peters  
Earl Applegate  
Hubert Long  
Clifford Davis  
Rudy Hilmyer  
Vernon Sigler  
A. Hazel

1934

E. Applegate  
Lorah Church  
Gertrude Black

1918 cont'd

Swais Wood  
Elsie Benson  
L. Renwick  
Viola Bovty  
F. Coffyn  
Lucile Waite  
F. Parke  
Mabel Ellis

1919

Lucy Harris  
S. Wood  
G. Makeever  
L. Renwick  
J.C. Trapnager  
Mildred Shiltz  
Madge Hammichouse  
Gladys Weber

1920

Dorothea Burdick  
J. Trapnager  
L. Harris

TOWNSHIP 29-N. RANGE 8-W

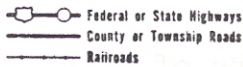

No. 3 North Star No. 1 Hooley No. 2 Wright No. 4 Mt. Ayr No. 5 Brown No. 7 Fleming No. 6 English

JACKSON

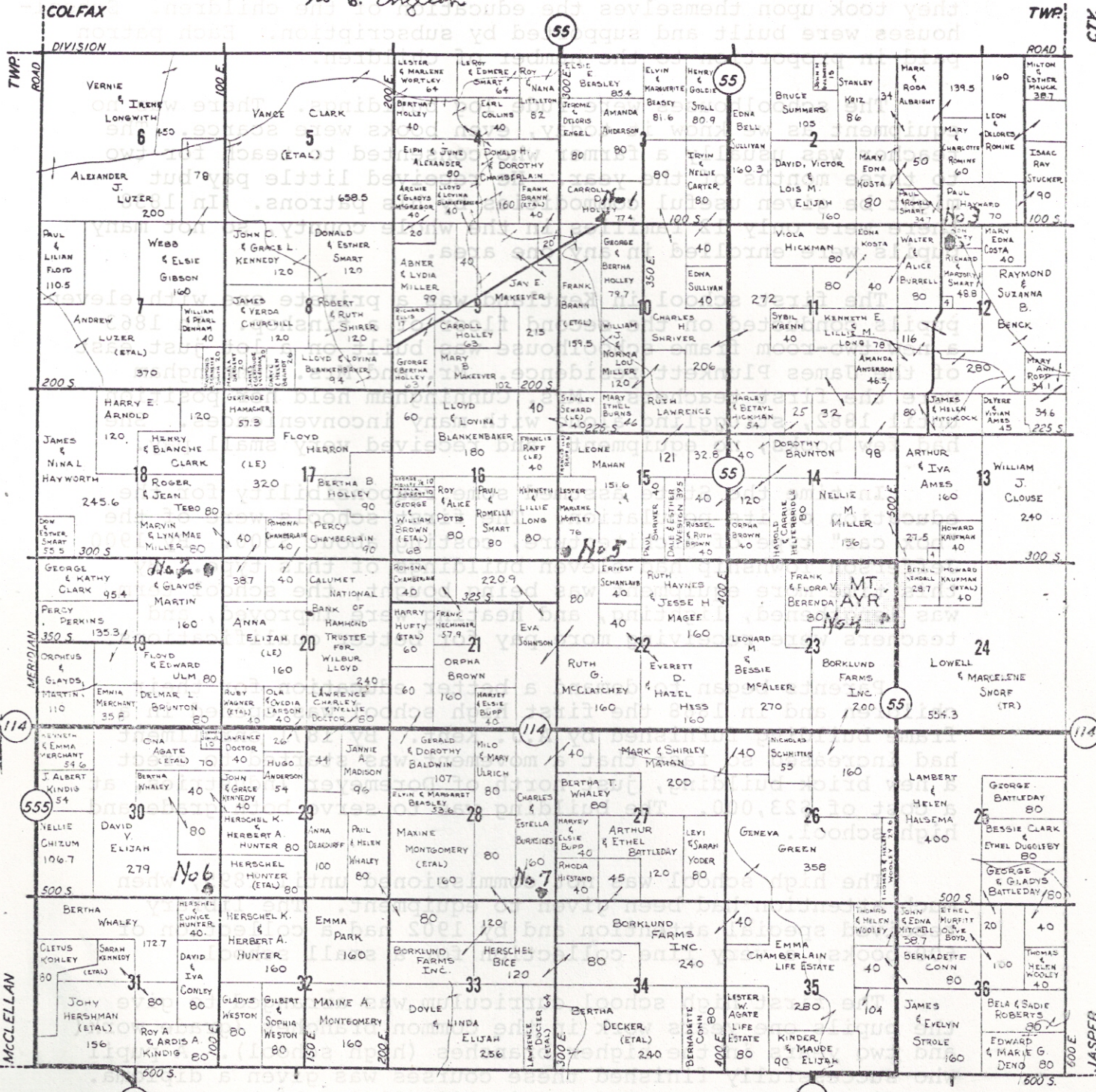

WASHINGTON TWP 555 IROQUOIS

55

TWP