

LAKE TOWNSHIP

The earliest known settlers in Lake Township included the Wades, who gave an acre of land where the first school was built in 1867. It was located just north of the present Lake Village Cemetery and was called the Wade School.

The Wades also donated an acre of land for the cemetery. In this cemetery was buried the renegade, Mike Shafer, who figured in many dishonest and evil deeds and was connected with the history of Bogus Island. The early school was a community center for everything from church to politics.

The first teacher of the Wade School was Meriah Jenkins. The length of the school term was one hundred twenty days with teacher's pay two dollars per day.

Other schools which came later were the North Star, located two miles east of Lake Village on old Route 10. The present home of Mrs. John Penkala is part of this school, closed in 1915.

Parsons School was located two miles west of Conrad on the south side of the road on the farm now belonging to Eryv Christenson. It was closed in 1921.

Another one of the early schools was the State Line School located northwest of the present home of Roy Boyd. This is one-half mile east of the Indiana-Illinois State Line on the road west of Lake Village. Lancy Sorenson who is 82 years old attended this school from 1901-1909 and gave this account of the type of school it was.

The building was made of rough lumber and had only two small windows. The seats were wooden with two and sometimes three pupils in one seat. The heat was furnished by a stove burning wood and in cold weather it was said that lunches often froze in the back of the room. There was no lighting of any kind. When a night meeting was held, the parents would bring lanterns.

Children walked as much as 2½ miles to get to school. The games played at noon and morning and afternoon recess were "Dare Base", "Stink Base", "Ring Around the Rosie", "Drop the Handkerchief" and "Andy Over".

Reading, writing, arithmetic along with some spelling, geography, and history were the subjects taught.

Many tales are told about one of Lake Village's well-liked

teachers, Maggie Hall, who taught here about 1892. She was "heavy" on the recitations, and liked to have her pupils learn "speakin" pieces so she picked out verses for them to say. It was a great delight for the older boys, when she asked them to speak what she had given them, to glibly answer:

"I saw a rat run up the wall,

I saw his tail and that was all."

A number of years later a "real" elocution teacher came to the town. She was Lorraine Jensen who later became Mrs. Alois Knapp, Alois at one time owning the Zoro Nature Park near Roselawn. Lorraine Jensen gave elocution lessons for several years to the youth of this area. Home talent plays were put on which later culminated in the very popular Community Clubs which brought all the family to the schoolhouse.

The only teacher's aids in the early schools were a globe of the world and a chalk board. Water was carried in from the well in a bucket and everyone wanting a drink used the same tin cup. The State Line School was closed in 1919.

All of the roads were sandy, muddy, or snow-covered. About 1920 some of the pupils who lived the farthest distance from the school were hauled in a horse-drawn vehicle called a "hack" which was a wagon with a cover over it and wooden bench-seats along the sides. In 1925 a Model T truck was used when the condition of the roads would permit.

In 1899 the school term was one hundred forty five days and the average teacher's salary was three hundred thirty four dollars for the term. The County Superintendent of schools at that time was W.L. Kellenberger.

The Graves School was located two miles southeast of Conrad near the present home of Cornelius Kros. This school was moved to Conrad in 1909. In 1921 a new brick two-room school was built in Conrad at the cost of \$11,861. This school was torn down in 1927 and the brick and furnishings used to build and furnish a two-room addition to the Lake Village School.

The Wade School was closed about 1908 and a two-story building was erected on what is now the playground for the present Lake Village school just east of the gymnasium. On the north end of the building was an outside rickety stairway that led to the upper floor. All pupils were housed in two large rooms—one upstairs and one below. This building was sold in 1915 and the upper story removed. The lower story

was moved to the north part of town to become a Catholic Church. Later it was purchased by the Oddfellows Lodge for a Lodge hall. When the Oddfellows Lodge disbanded it was bought by Clark Shuler to make a hatchery and dwelling place. It is at present the home of the Lake Village Grange.

In 1914 a four-room brick building was built at Lake Village just east of the gymnasium. The cost was nine thousand dollars. In 1934 two rooms were added on the east side using bricks from the Conrad School as stated before.

In 1924 a bus was bought to transport pupils to Morocco High School. Up to this time they had to furnish their own transportation.

In 1939 the Lake Village gymnasium was built at a cost of \$36,550. It was used for gym classes and school functions as well as other community gatherings.

The present Lake Township School was dedicated in 1962. The old school was sold and torn down the next year.

Mr. W.O. Schanlaub served as superintendent of Newton County schools from 1907 to 1951. Many of the advances in the school system can be credited to his leadership.

LAKE TOWNSHIP'S TEACHERS

1907

Kathryn Brady
Lottie Hess
Eunice Brown
John Bunch

1908

Charles Martin
Kathryn Brady
Belle Strickler
Jesse Hunter
Miss Wilgermiph
W.O. Carrothers

1909

Maude Smart
Irene Roadruck
Mayme Brady
Kathryne Brady
Christine Walgenmuth
Maude Wann

1910

Katherine Brady
Irene Roadruck
Maude Smart
Madeline McClain
Maude Wann
Ina Hess

1911

Fannie Smart
Maude Smart
Madeline McClain
Vernie Hayworth
Grace Nantz
Louvisa Clarkson

1912

Susie Beahm
Ninah Mann
Vernie Hayworth
Lenore Winters
Louvisa Clarkson
Fannie Smart

1913

Louvisa Clarkson
Estella Clarkson
Ruby Hyde
Ninah Mann
Lenora Winters
Laura Reed

1914

Louvisa Clarkson
Lenora Winters
Bethel Murphy
Flossie Williams
Beulah Jackson

1915

May Goodacre
Flossie Williams
Mary L. Williams
Louvisa Clarkson
Beulah M. Jackson

1916

May Goodacre
Nell Rigdon
Frances Winters
J.V. Mendenhall
Lenora Stumbaugh

1917

May Goodacre
Nell Rigdon
Lenora Stumbaugh
J.V. Mendenhall
Florence Sullivan

1918

Viola Goodacre
May Goodacre
Winona Fulleton
Florence Sullivan
Harriet Thurston

1919

Edna Mintner
Winona Fulleton
May Goodacre
Leva Standid

1920

Mande Harrell
Zella Bess
Winona Fulleton
Edna Mintner

1921

Lee Crane
Maude Harrell
Winona Fulleton
Zella Bess

1922 Lake Village

Darney Ridge
Gay Makeever

Conrad

Zella Bess
Lee Crane

1923 Lake Village	1930 Lake Village from now on
Orpha L. Cox	Lloyd Arbuckle
R.C. Minger	Lucille Carlson
	Edna Vail
Conrad	
Zella Bess	1931
L. Crane	same
1924 Lake Village	1932
Sydney Carlson	Lloyd Arbuckle
Mae Turner	Elsaleah Miller
Conrad	Edna Vail
Lee Crane	
Merna B. Madison	1933
	Ashel O. Hawkins
1925 Lake Village	Elsaleah Miller
R. Monger	Edna Vail
Orpha Cox	Ruth Robinson
Conrad	
Lee Crane	
Merna Madison	
1926 Lake Village	
Sydney Carlson	
Merna Madison	
Gertrude Jennings	
Conrad	
Lee Crane	
1927 & 1928 L. Village	
Sydney Carlson	
Merna Madison	
Gertrude Jennings	
1929 Lake Village	
Wayne Biay E. Vail	
Lucille Ewart	

TOWNSHIP 31-N. RANGE 9 & 10-W.

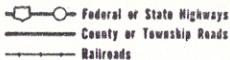

1 North Star
2 Lake Village
3 State Line
4 Wagon School
5 Wades School
6 Lakes School
7 Lockport

LAKE

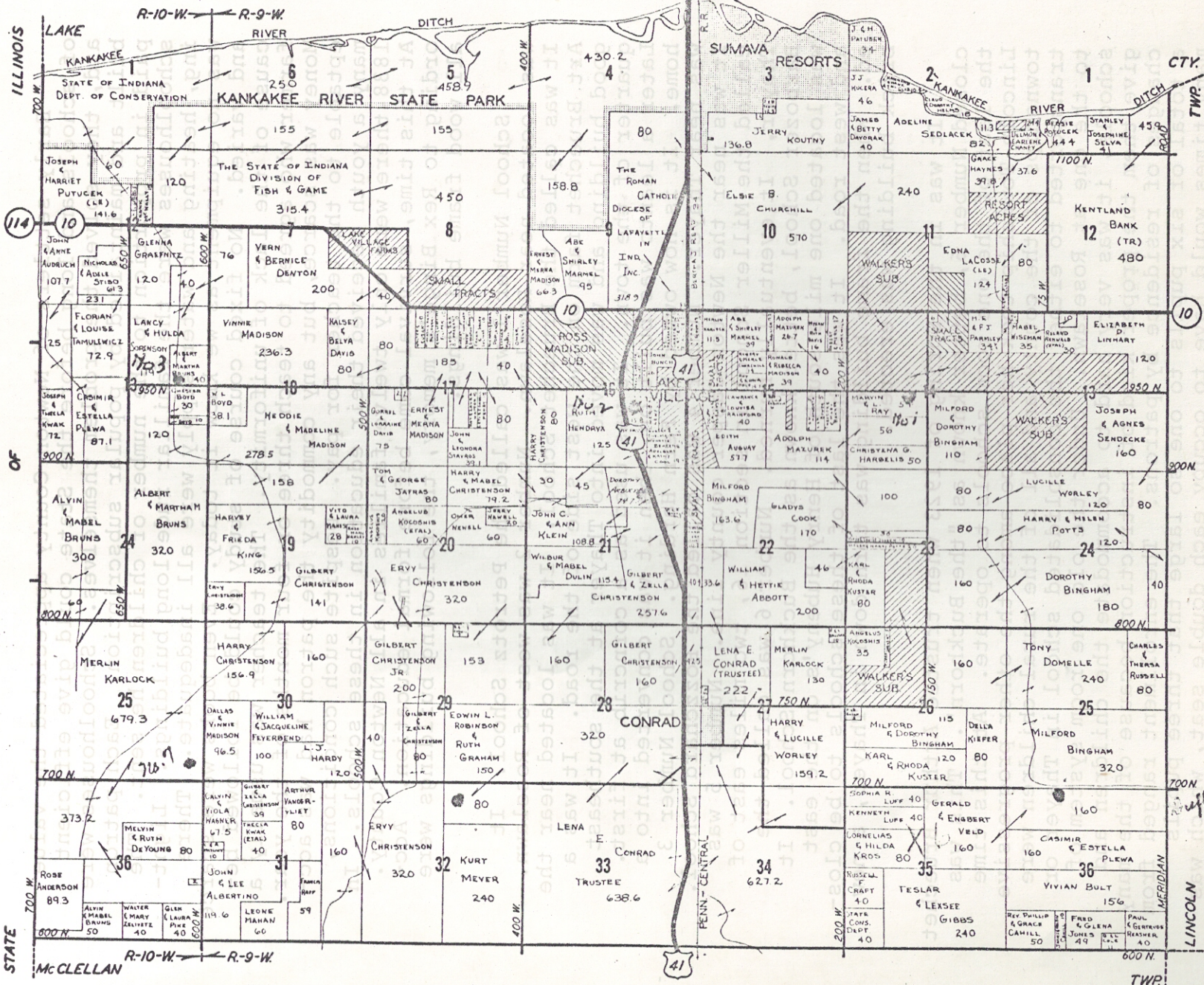

ILLINOIS

OF

STATE

CTY. TWP.

10

300N

800N

700N

600N

LINCOLN TWP.

R-10-W R-9-W

41

TWP.

uffy

MERIDIAN

STATE

LAKE

LAKE