

## McCLELLAN TOWNSHIP

In 1904 there were five one room schools in this district. They were No. 1 School called Ellis South named after Andrew Ellis. No. 2 School was called Cherry Island. Oak Grove was No. 3 School. Andrew Ellis had another school named after him. This one was called No. 4 Ellis North. Templeton was the title given No. 5 School.

The first departure from the "shoe-box" type of rural schools in Newton county was the erection of a new school building at Enos, in the year 1915--a picture of which appears in this article. The building was erected by Ora Sellers, township trustee. The main schoolroom was 23 by 33 feet, the recitation room 11 by 6 feet; the library room 8 by 11 feet. It was the only building of its kind at that time in the county and was to serve as a model for county schools that, of necessity, might be maintained outside of large consolidated districts, at a minimum cost. It provided for two teachers and many conveniences not found in the one-room school houses. The building was heated by schoolroom furnaces. It was used for Sunday School, church, and other community meetings.

The construction of this schoolhouse was made necessary because a fire had destroyed the one-room school building which was located at the same site. The old building was constructed while Elmer Skinner was township trustee. On January 22, 1920 the new school house which was the pride of the school patrons of McClellan township was burned. Plans were then made for a much larger and more modern school building. The building has two large recitation rooms, rest and library room suitable for all kinds of meetings, and has a modern steam heating plant. It has its own water system, which is controlled by an automatic electric pump. In fact, everything about the building is modern. The playground is also equipped with necessary play apparatus. The present building was erected at a cost of about \$31,000. The people of the community are naturally proud of their school plant. Ora Sellers, trustee, was in charge of construction of the building.

On November 10, 1921 an attempt was made to burn the brick building then new. Entrance to the building was gained by breaking a window. A pile of old rags and other material was placed in the room under the stage and was saturated with coaloil in such liberal quantities that some of the oil ran under the door into an adjoining room.

The material was ignited and the door closed, and this alone saved the building. When the oxygen in the room was consumed the fire died. In the foregoing fires Newton County lost two voting machines. One is now housed in the present building.

In 1907 the four one-room schools in this township had been reduced to two and the teachers were Jesse Hunter and R.C. Bowton. Since that time the following teachers have been employed:

- |           |  |
|-----------|--|
| (1908-09) | R.C. Bowton<br>Carrie Sowers   |
| (1909-10) | Estella M. Clarkson<br>Viola McCabe<br>Lawson L. Archibald<br>Ina Hess |
| (1910-11) | Iva Winters<br>Sadie E. Illingworth<br>Lenora Winters                  |
| (1911-12) | Mrs. J.C. Hodgson<br>Sadie E. Illingworth                              |
| (1912-13) | Harrison Williamson<br>Sadie E. Illingworth<br>Bessie Rust             |
| (1913-14) | Harrison Williamson<br>Margaret Silver<br>Bessie Rust                  |
| (1914-16) | Ruth Archibald<br>Harrison Williamson                                  |
| (1916-17) | Estella Clarkson<br>Lenora Winters<br>Clinton Williamson               |
| (1917-18) | Bernice Kitts<br>Estella Clarkson                                      |
| (1918-19) | Bernice Kitts<br>Mary Brown<br>Ruth Dodson                             |
| (1919-20) | Bernice Kits<br>Olive Morgan<br>Ruth Dodson                            |

- (1920-21) Ruth Dodson  
Marie O'Reilly
- (1921-22) Zoe Hoard  
Opal Boughner  
Marie O'Reilly
- (1922-23) Sidney Carlson, Advanced  
Tessie M. Timmons, Primary
- (1923-24) Maydene W. Williamson, Advanced  
Tessie M. Timmons, Primary
- (1924-25) Estella Clarkson, Advanced  
Tessie M. Timmons, Primary
- (1925-28) Estella Clarkson, Advanced  
Cora M. Kalfise, Primary
- (1928-29) Kenneth K. Edwards, Advanced  
Tessie M. Sheets, Primary
- (1929-30) Sydney Carlson, Advanced  
Tessie M. Sheets, Primary
- (1930-31) F.H. Scott, Advanced  
Beulah Bowers, Primary
- (1931-32) Ottis Smith, Advanced  
Tessie Timmons Sheets, Primary
- (1950-54) Hilda Suddarth, Grades 5-8  
Flossie Perkins, Grades 1-4
- (1954-55) Hilda Suddarth, Grades 5-8  
Flossie Perkins, Grades 1-4  
Betty Cook, Music and Art
- (1956-59) Dennis McDonald, Grades 5-8  
Flossie Perkins, Grades 1-4
- (1959-60) Virginia Davis, Grades 4-6  
Esther Donovan, Grades 1-3
- (1960-63) Virginia Davis, Grades 4-6  
Bernice Lyons, Grades 1-3
- (1964-65) Virginia Davis, Grades 4-6  
Pauline Parke, Grades 1-3
- (1965-66) Virginia Davis, Grades 4-6  
Billie Sue Bingham, Grades 1-3

Federal or State Highways  
County or Township Roads  
Railroads

No 1 Spinner School 5. Ellis  
No 2 Cherry Island  
3 Oak Grove  
4 McClelland

# McCLELLAN

ILLINOIS

STATE OF BEAVER

TWP

COLFAX

TWP

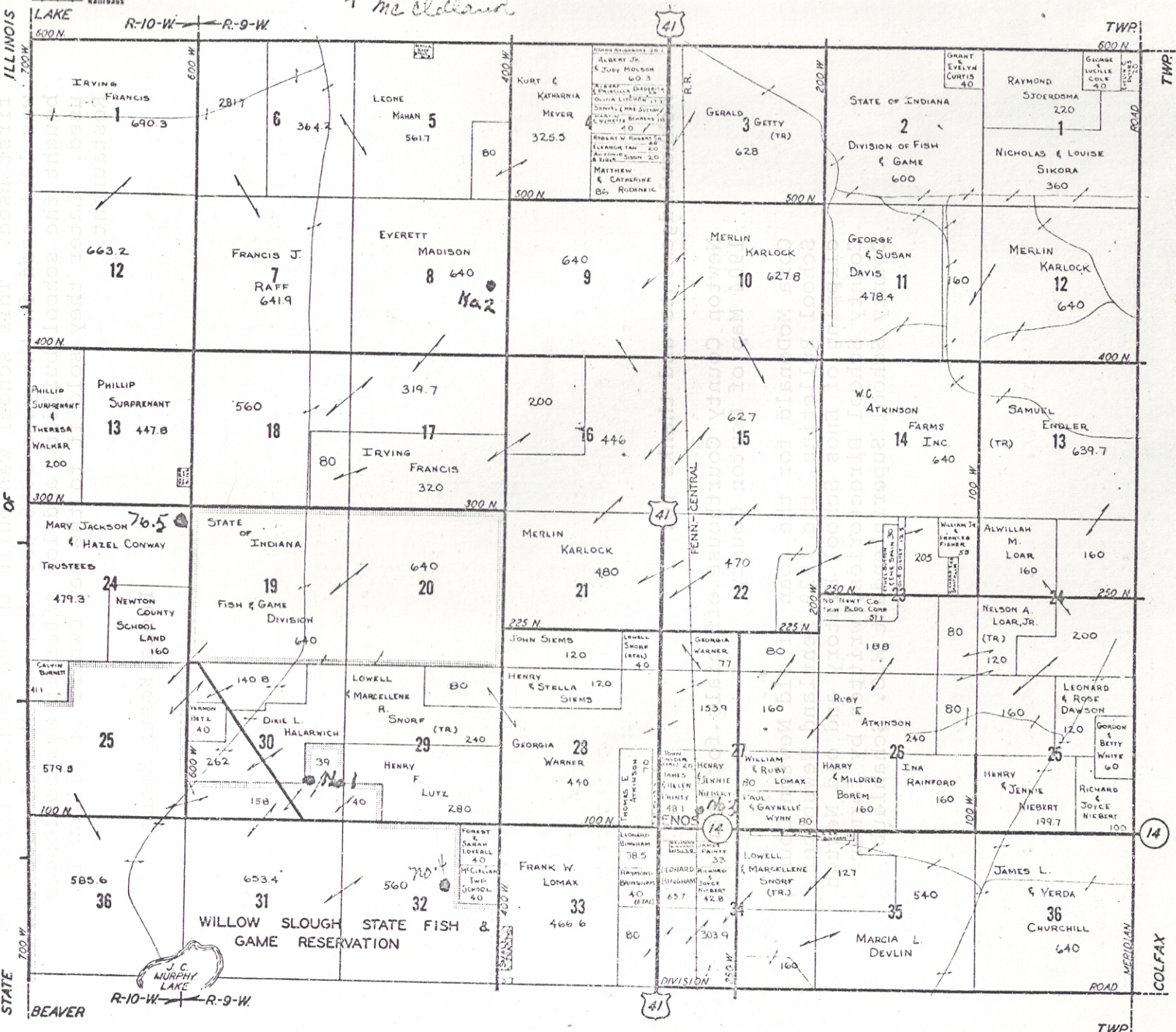

R-10-W ← R-9-W

R-10-W ← R-9-W

TWP

ROAD

TWP

In 1920 The new McClellan Consolidated School was first used. This school was built in the town of Enos. It was last used in the year 1965-66. Mr. and Mrs. Lawson Cox bought the school building and lot after it was no longer used. Later they sold it to the new owners of Willow Inn Restaurant.

Leona Kosta Kanne

Acknowledgements and thanks to:

Newton County Courthouse officials for loan of 1904 Map of Newton County

Cora McDonald for the loan of old Newton County School Bulletins, the 1929 Kentland Newspaper clipping of Enos School History and old Newton County School Directories, written by former County School Superintendent W.O. Schanlaub